



Ifield Road, SW10

£450 Per week

A newly refurbished one bedroom flat to let furnished in Earls Court and arranged over the Raised Ground floor of a Victorian house located just south of Old Brompton Road and close to Earls Court.

Close to Earls Court Road and Fulham Road with a selection of shops and cafes including 24 hour Tesco supermarket, Marks and Spencer Simply Foods, Starbucks coffee shop and Wagamamas restaurant. Earls Court Underground is a short distance providing links to the city via the Piccadilly or District lines.

Features

- Wooden Floors Throughout
- High Ceiling's
- Light And Bright
- Excellent Location
- Large Double Bedroom
- New Kitchen And Bathroom

Ifield Road,
London, SW10

Ground Floor

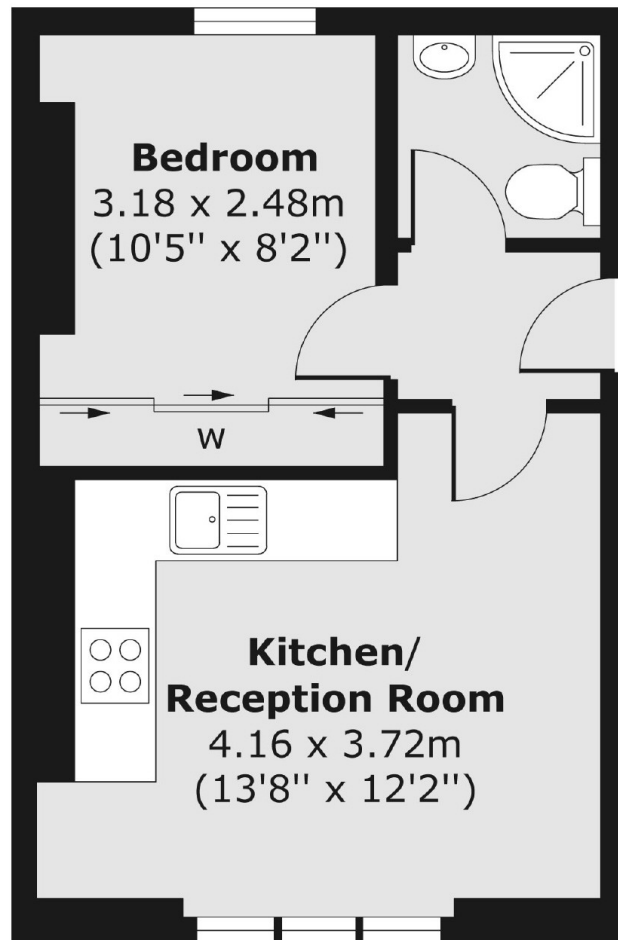

Total area (approx.) 26.71 sq. m (288 sq. ft)