



Ifield Road, SW10

£510 Per week

A beautifully finished one bedroom flat arranged over the third floor of a Victorian house and located just south of Old Brompton Road and close to Earls Court.

Close to Earls Court Road and south of Old Brompton Road with a selection of shops and cafes including 24 hour Tesco supermarket, Marks and Spencer Simply Foods, Starbucks coffee shop and Wagamamas restaurant. Earls Court Underground is within a mile away.

Features

- Spacious Double Bedroom
- Built In Storage
- Brand New Bathroom
- New Modern Kitchen
- First Floor
- Quiet Residential Street

Ifield Road, London, SW10

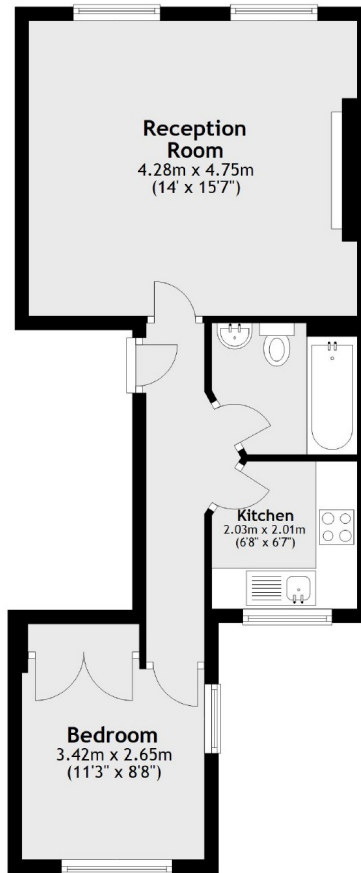

Total area: approx. 42.5 sq. metres (457.2 sq. feet)