



Queen's Gate Terrace, SW7

£975 Per week

A one bedroom apartment on the ground floor of this period building in the heart of South Kensington. The property has an en suite shower room and reception room with a fully equipped open plan kitchen.

Queen's Gate Terrace is a quiet Victorian terrace, conveniently located between Queen's Gate and Gloucester Road so well located for Imperial College, Hyde Park, South Kensington and Knightsbridge.

Features

- Newly Renovated
- Spacious Double Bedroom
- Wooden Flooring
- Ground Floor
- High Ceilings
- Built In Storage

Queen's Gate Terrace, London, SW7

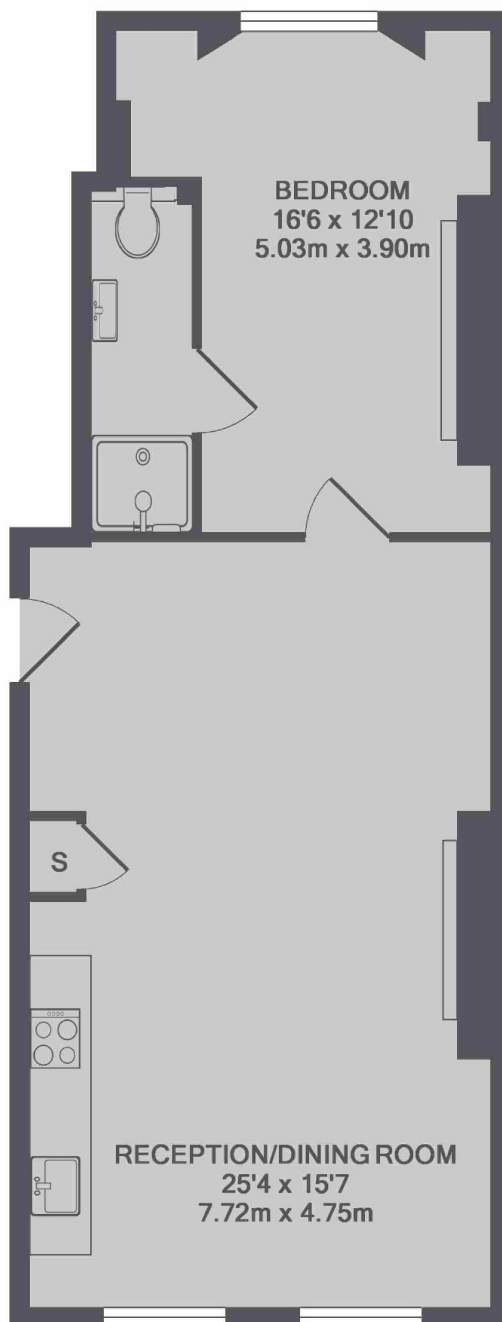

TOTAL APPROX. FLOOR AREA 618 SQ.FT. (57.4 SQ.M.)