



Pont Street, SW1X

£6,950 Per week

An amazing property with a private garden to rent in Knightsbridge in well maintained portered block. The property has been newly refurbished and benefits from two reception rooms, four double bedrooms and four bathrooms.

Pont Street is located in the heart of Knightsbridge just off Sloane Street close to the shops and restaurants of Brompton Road and Sloane Square.

Features

- Private Gardens
- Three Large Bedroom
- Porter
- Newly Refurbished
- Double High Ceilings
- Ample Storage
- Three Bathroom
- Excellent Location



Pont Street, SW1X



Pont Street, London, SW1X

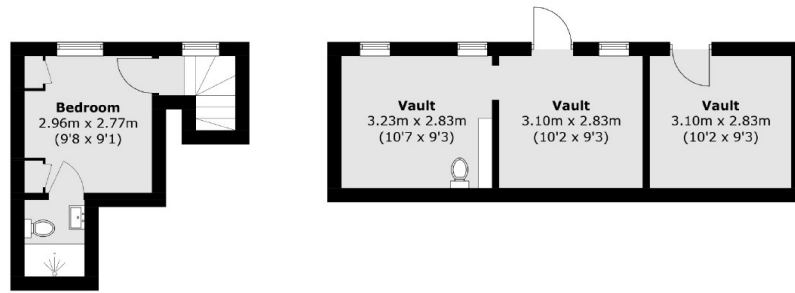

Mezzanine



Lower Ground Floor

Ground Floor

Total area (approx.): 238.8 sq. m (2,569.2 sq. ft)
(Including Mezzanine)
Vaults: 27.9 sq. m (300.3 sq. ft)