



Earl's Court Square, SW5

£1,100,000

An exceptional second floor two-bedroom flat with use of the award-winning Earls Court Square gardens.

Earls Court Square is a quiet oasis in the prestigious 19th century residential area in South Kensington, a short walk to the Earls Court and West Brompton stations and well located for quick access to the A4/M4 towards Heathrow Airport.

Features

- Two Double Bedrooms
- One Bathroom
- Open Plan Kitchen Reception
- Second Floor
- Access To Private Garden
- Long Lease



Earl's Court Square, SW5

Comprising of a welcoming hallway, two large double bedrooms, an open plan reception room, family bathroom and large storage cupboard. The apartment has impressive high ceiling throughout further benefiting from a private balcony overlooking the garden square.

The second double bedroom has direct views over the garden square equally finishes to a meticulous standard and high ceilings. The open plan reception and kitchen has amazing grand high ceilings, lots of natural light and direct access to the private balcony.



Earl's Court Square, London, SW5

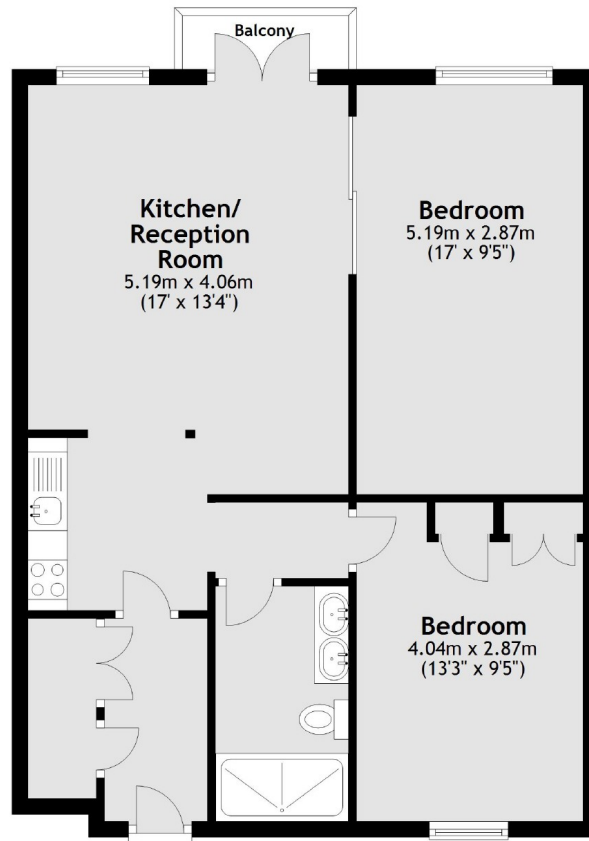

Main area: Approx. 65.4 sq. metres (703.9 sq. feet)
Plus balcony, approx. 1.6 sq. metres (17.7 sq. feet)