



Hyde Park Estate, London W2

Hyde Park Estate, London W2

Located on the prestigious Hyde Park Estate, this is a well-presented, recently refurbished, larger type raised ground floor three bedroom apartment measuring approximately 125.3 sq. m. (1349 sq. ft.).

The property comprises of a sizeable reception room with ample space for dining and a separate fitted kitchen with ample workspace, fitted cabinets and integrated appliances. Accessed from the main hallway, a great principal bedroom with fitted wardrobes and an en suite shower room, second bedroom with fitted wardrobes, third bedroom or study and contemporary family shower room.



Guide price: £1,500,000

Tenure: Leasehold: approximately 151 years remaining

Service charge: £11,348 per annum, reviewed every year, next review due 2025

Local authority: City of Westminster

Council tax band: H





The Quadrangle is a gated development and features a communal garden and concierge. This apartment is ideally situated with garden views from both back and front and onsite parking can be rented via separate negotiation. This is a gated development and features a communal garden and 24 hour concierge service.

The building is located on the prestigious Hyde Park Estate, offering easy access to the beautiful open spaces of Hyde Park and the boutique shops and restaurants of Connaught Village and Marylebone. Nearest stations include Marble Arch (Central line), Paddington mainline (Network Rail, Heathrow Express), Elizabeth line and underground (Hammersmith & City, Circle, Bakerloo and District lines) and Edgware Road (Bakerloo line) are all within close proximity.



The Quadrangle, W2

Approximate Area = 125.3 sq m / 1349 sq ft
Including Limited Use Area (2.1 sq m / 23 sq ft)

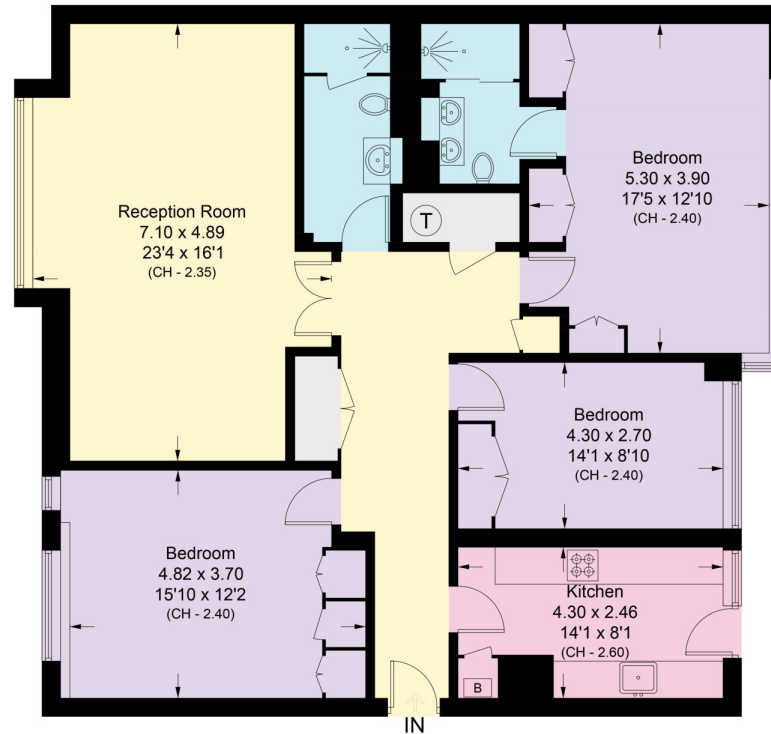

Ground Floor

Approximate Area = 125.3 sq m / 1349 sq ft
Including Limited Use Area (2.1 sq m / 23 sq ft)

This plan is for guidance only and must not be relied upon as a statement of fact. Attention is drawn to the important notice on the last page of the text of the Particulars.

Knight Frank

Hyde Park

1 Craven Terrace

London

W2 3QD

[knightfrank.co.uk](https://www.knightfrank.co.uk)

I would be delighted to tell you more

Mark Ruffell

020 3697 8234

mark.ruffell@knightfrank.com



Fixtures and fittings: A list of the fitted carpets, curtains, light fittings and other items fixed to the property which are included in the sale (or may be available by separate negotiation) will be provided by the Seller's Solicitors.

Important Notice: 1. Particulars: These particulars are not an offer or contract, nor part of one. You should not rely on statements by Knight Frank LLP in the particulars or by word of mouth or in writing ("information") as being factually accurate about the property, its condition or its value. Neither Knight Frank LLP nor any joint agent has any authority to make any representations about the property, and accordingly any information given is entirely without responsibility on the part of the agents, seller(s) or lessor(s). 2. Photos, Videos etc: The photographs, property videos and virtual viewings etc. show only certain parts of the property as they appeared at the time they were taken. Areas, measurements and distances given are approximate only. 3. Regulations etc: Any reference to alterations to, or use of, any part of the property does not mean that any necessary planning, building regulations or other consent has been obtained. A buyer or lessee must find out by inspection or in other ways that these matters have been properly dealt with and that all information is correct. 4. VAT: The VAT position relating to the property may change without notice. 5. To find out how we process Personal Data, please refer to our Group Privacy Statement and other notices at <https://www.knightfrank.com/legals/privacy-statement>.

Particulars dated April 2024. Photographs and videos dated April 2024.

Knight Frank is the trading name of Knight Frank LLP. Knight Frank LLP is a limited liability partnership registered in England and Wales with registered number OC305934. Our registered office is at 55 Baker Street, London W1U 8AN where you may look at a list of members' names. If we use the term 'partner' when referring to one of our representatives, that person will either be a member, employee, worker or consultant of Knight Frank LLP and not a partner in a partnership. If you do not want us to contact you further about our services then please contact us by either calling 020 3544 0692, email to marketing.help@knightfrank.com or post to our UK Residential Marketing Manager at our registered office (above) providing your name and address.