

# Queensborough Terrace, Hyde Park W2

---



# Queensborough Terrace, Hyde Park W2

Located on the third floor of a white stucco fronted building with lift, the apartment has large windows, flooding the space with an abundance of natural light. The property is neutrally decorated throughout and measures approximately 66 sq. m. (710 sq. ft.).

Accommodation comprises generous open-plan reception room with ample space for dining, two double bedrooms and a family bathroom. One final benefit to note is the residents only communal roof terrace that affords far-reaching views across the London skyline.



**Guide price:** £995,000

**Tenure:** Share of freehold plus leasehold, approximately 977 years remaining

**Service charge:** £5,210.86 per annum plus £1,184 reserve fund, reviewed every year, next review due 2025

**Local authority:** City of Westminster

**Council tax band:** F







## Location

Queensborough Terrace is centrally located with excellent transport links such as Queensway (Central line) and Bayswater (District, Circle) stations close by. Slightly further afield is Paddington station for the Elizabeth line, National Rail and underground.

Oxford Street and the West End are both easily accessible offering some of the best shops, restaurants and theatre London has to offer.

Queensborough Terrace is also perfectly positioned for the amenities of Queensway and the open spaces of Hyde Park.



## Queensborough Terrace, W2

Approximate Gross Internal Area = 66.0 sq m / 710 sq ft

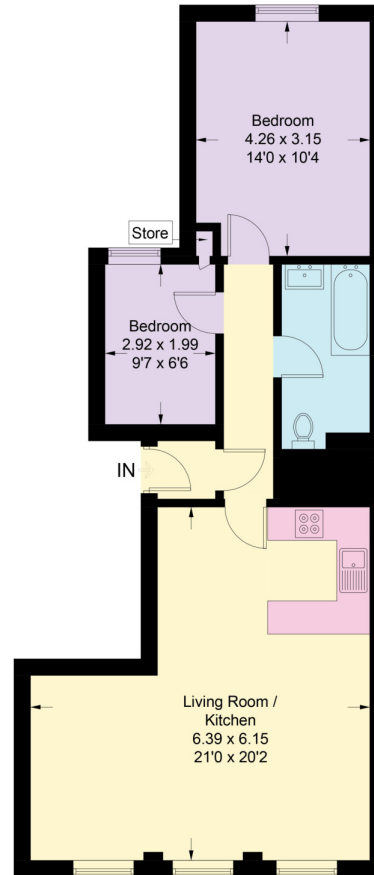

Third Floor

This plan is for guidance only and must not be relied upon as a statement of fact. Attention is drawn to the important notice on the last page of the text of the Particulars.

**Knight Frank**

**Hyde Park**

1 Craven Terrace

London

W2 3QD

[knightfrank.co.uk](https://www.knightfrank.co.uk)

I would be delighted to tell you more

**Mark Ruffell**

020 3697 8234

[mark.ruffell@knightfrank.com](mailto:mark.ruffell@knightfrank.com)



Fixtures and fittings: A list of the fitted carpets, curtains, light fittings and other items fixed to the property which are included in the sale (or may be available by separate negotiation) will be provided by the Seller's Solicitors.

Important Notice: 1. Particulars: These particulars are not an offer or contract, nor part of one. You should not rely on statements by Knight Frank LLP in the particulars or by word of mouth or in writing ("information") as being factually accurate about the property, its condition or its value. Neither Knight Frank LLP nor any joint agent has any authority to make any representations about the property, and accordingly any information given is entirely without responsibility on the part of the agents, seller(s) or lessor(s). 2. Photos, Videos etc: The photographs, property videos and virtual viewings etc. show only certain parts of the property as they appeared at the time they were taken. Areas, measurements and distances given are approximate only. 3. Regulations etc: Any reference to alterations to, or use of, any part of the property does not mean that any necessary planning, building regulations or other consent has been obtained. A buyer or lessee must find out by inspection or in other ways that these matters have been properly dealt with and that all information is correct. 4. VAT: The VAT position relating to the property may change without notice. 5. To find out how we process Personal Data, please refer to our Group Privacy Statement and other notices at <https://www.knightfrank.com/legals/privacy-statement>.

Particulars dated April 2024. Photographs and videos dated April 2024.

Knight Frank is the trading name of Knight Frank LLP. Knight Frank LLP is a limited liability partnership registered in England and Wales with registered number OC305934. Our registered office is at 55 Baker Street, London W1U 8AN where you may look at a list of members' names. If we use the term 'partner' when referring to one of our representatives, that person will either be a member, employee, worker or consultant of Knight Frank LLP and not a partner in a partnership. If you do not want us to contact you further about our services then please contact us by either calling 020 3544 0692, email to [marketing.help@knightfrank.com](mailto:marketing.help@knightfrank.com) or post to our UK Residential Marketing Manager at our registered office (above) providing your name and address.