



A town centre two bedroom ground floor maisonette with a private garden
Murray Road, Northwood, HA6 2YL



Asking Price: £2,050 pcm

A town centre two bedroom ground floor maisonette with a private garden

Murray Road, Northwood, HA6 2YL

• ENTRANCE HALL • LIVING/DINING ROOM WITH PATIO DOORS • FITTED KITCHEN • TWO BEDROOMS ONE WITH FITTED WARDROBES • BATHROOM • PRIVATE REAR GARDEN • PERMIT PARKING AVAILABLE • FURNISHED

Description

This spacious ground-floor maisonette blends period charm with modern comfort. Featuring high ceilings, an original fireplace, and over 800 sq ft of living space, it offers two double bedrooms, a bright lounge, and a large private garden with patio and shed, a newly refreshed bathroom and a kitchen including a gas hob, dishwasher, washing machine, and separate dryer. Fully furnished throughout and ideal for professionals or a small family.

**** An advance reservation payment of one weeks rent is required to secure the property ****

Location

Northwood provides a range of shopping facilities including a Waitrose supermarket, a variety of restaurants and other amenities with the Metropolitan Line station providing access to Baker Street and the City. There is a plethora of state and private schooling together with a wide choice of recreational facilities, which include golf courses and fitness centres. The M1, M40 and M25 motorways are also accessible.





Additional Information

- Local Authority: Hillingdon
- Council Tax Band: D
- Deposit Amount: £2,365.00
- Reservation Payment: One weeks rent
- Energy Efficiency Rating: Band D
- Available Date: 05/01/2026

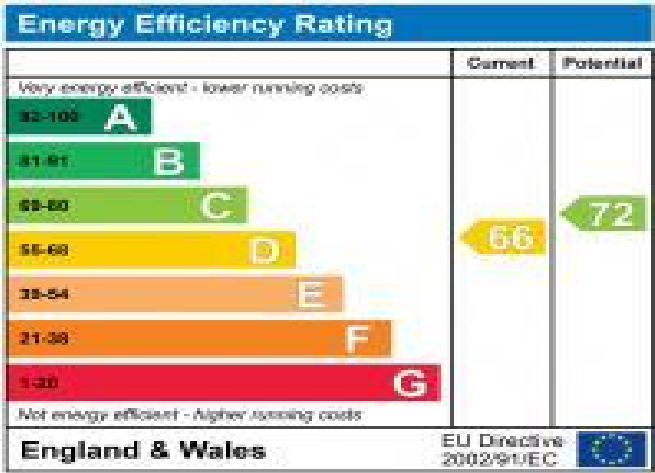

Murray Road, Northwood, HA6 2YL

Approximate Gross Internal Area

Main House = 78 Sq M/840 Sq Ft

Outbuilding = 9 Sq M/97 Sq Ft

Total = 87 Sq M/937 Sq Ft

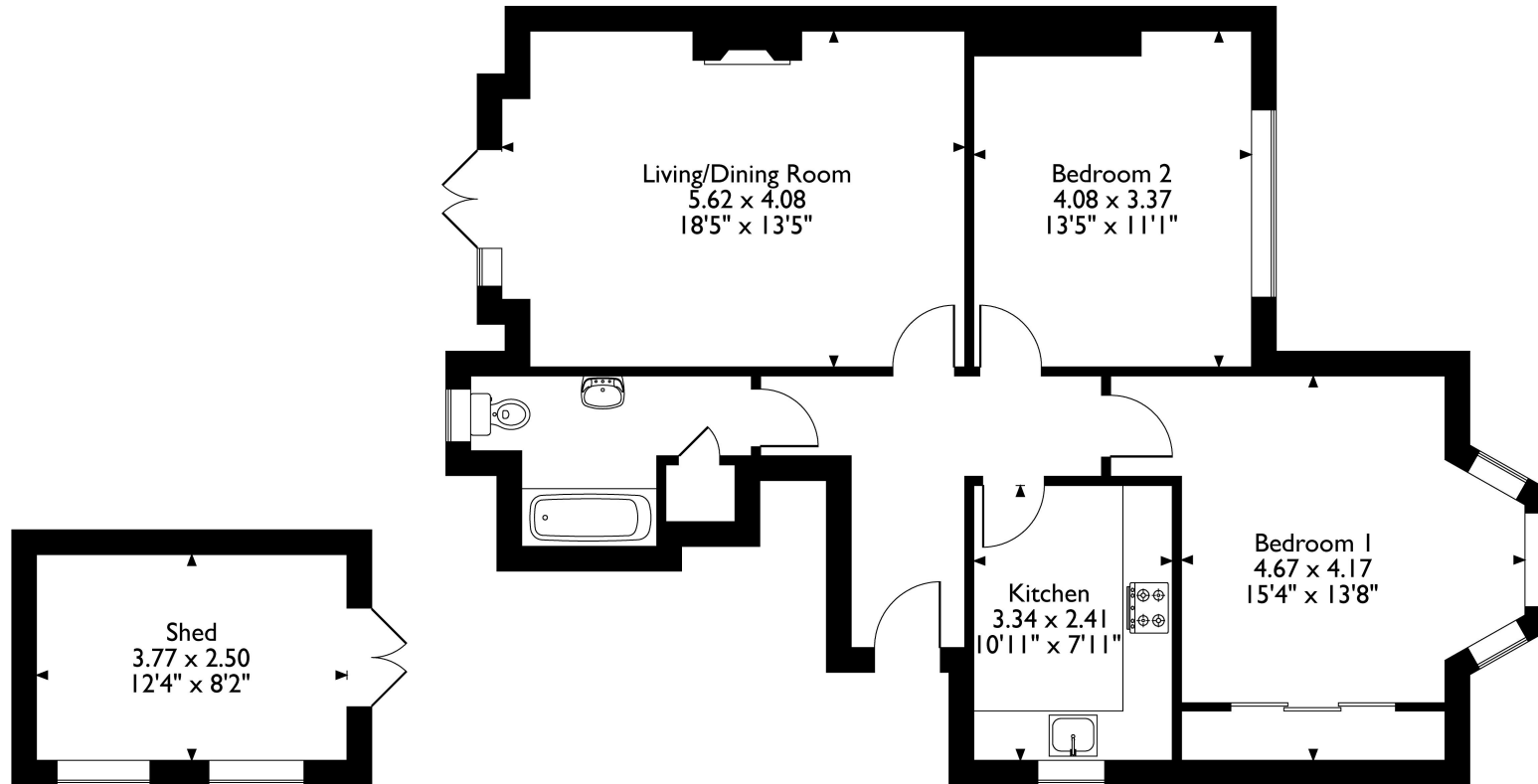

Outbuilding

Ground Floor

Please note the floorplan is for layout guidance only and is not drawn to scale unless stated. Windows and door openings are approximate. Whilst every care is taken in the preparation of this plan, please check all dimensions, square footages and shapes before making any decisions reliant upon them.



REGISTERED OFFICE 2-4 PACKHORSE ROAD, GERRARDS CROSS, BUCKINGHAMSHIRE, ENGLAND, SL9 7QE. COMPANY NO. 07557114. VAT NO. GB211239453