



A three bedroom end of terrace home in a quiet cul de sac
Closemead Close, Northwood, HA6 2SA



Asking Price: £2,650 pcm

A three bedroom end of terrace home in a quiet cul de sac

Closemead Close, Northwood, HA6 2SA

• END OF TERRACE HOUSE • THREE BEDROOM • TWO BATHROOMS • LIVING ROOM • KITCHEN with APPLIANCES • FRONT DRIVEWAY • REAR GARDEN • FURNISHED or UNFURNISHED

Description

A charming three-bedroom end of terrace family home located in a quiet cul-de-sac in Northwood. The property features a spacious living room with bi-fold doors opening to a private rear garden, a large kitchen with appliances and space for a dining table, and an under-stair storage cupboard. The master bedroom includes an en-suite shower room, with a family bathroom serving the other two bedrooms. The property also offers a front driveway with space for multiple vehicles.

**** An advance reservation payment of one weeks rent is required to secure the property ****

Location

Northwood provides a range of shopping facilities including a Waitrose supermarket, a variety of restaurants and other amenities with the Metropolitan Line station providing access to Baker Street and the City. There is a plethora of state and private schooling together with a wide choice of recreational facilities, which include golf courses and fitness centres. The M1, M40 and M25 motorways are also accessible.





Additional Information

- Local Authority: Hillingdon
- Council Tax Band: E
- Deposit Amount: £3,057.00
- Reservation Payment: One weeks rent
- Energy Efficiency Rating: Band C
- Available Date: 17/07/2025

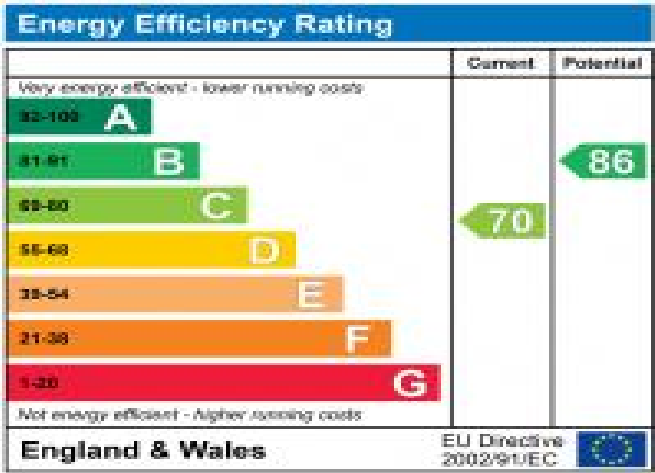

Approximate Gross Internal Area
 Ground Floor = 38.3 sq m / 412 sq ft
 First Floor = 38.4 sq m / 413 sq ft
 Total = 76.7 sq m / 825 sq ft

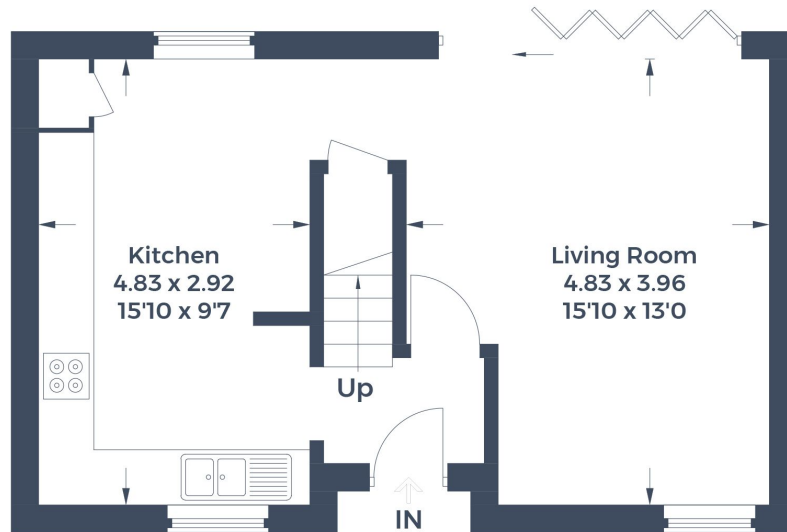

Ground Floor

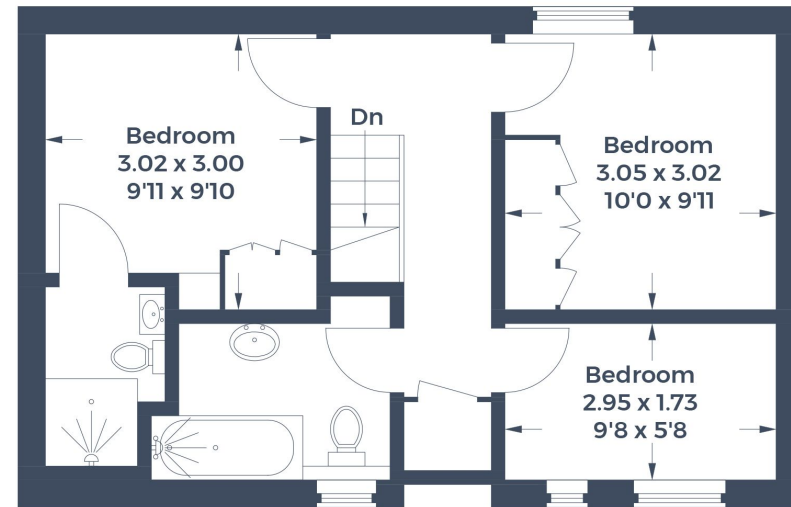

First Floor

This plan is for layout guidance only. Not drawn to scale unless stated. Windows and door openings are approximate. Whilst every care is taken in the preparation of this plan, please check all dimensions, shapes and compass bearings before making any decisions reliant upon them.

© CJ Property Marketing Produced for Robsons

