



## Beames Road, NW10

### £325,000

Set within a modern secure development is this one bedroom flat on the second floor with lift access. Kept in excellent condition throughout, the property has a south facing balcony and communal garden, fully integrated kitchen, and is available chain-free.

Melody House is located on Emerald Road near to the shops, cafes and amenities on Craven Park and Harlesden High Street, and in close proximity to Roundwood Park. Transport links include Harlesden (Bakerloo & Overground) and Stonebridge Park (Bakerloo & Overground).

### Features

- One Bedroom
- One Bathroom
- Excellent Condition
- South Facing Balcony
- Lift Access
- Chain-Free

# Beames Road, London, NW10

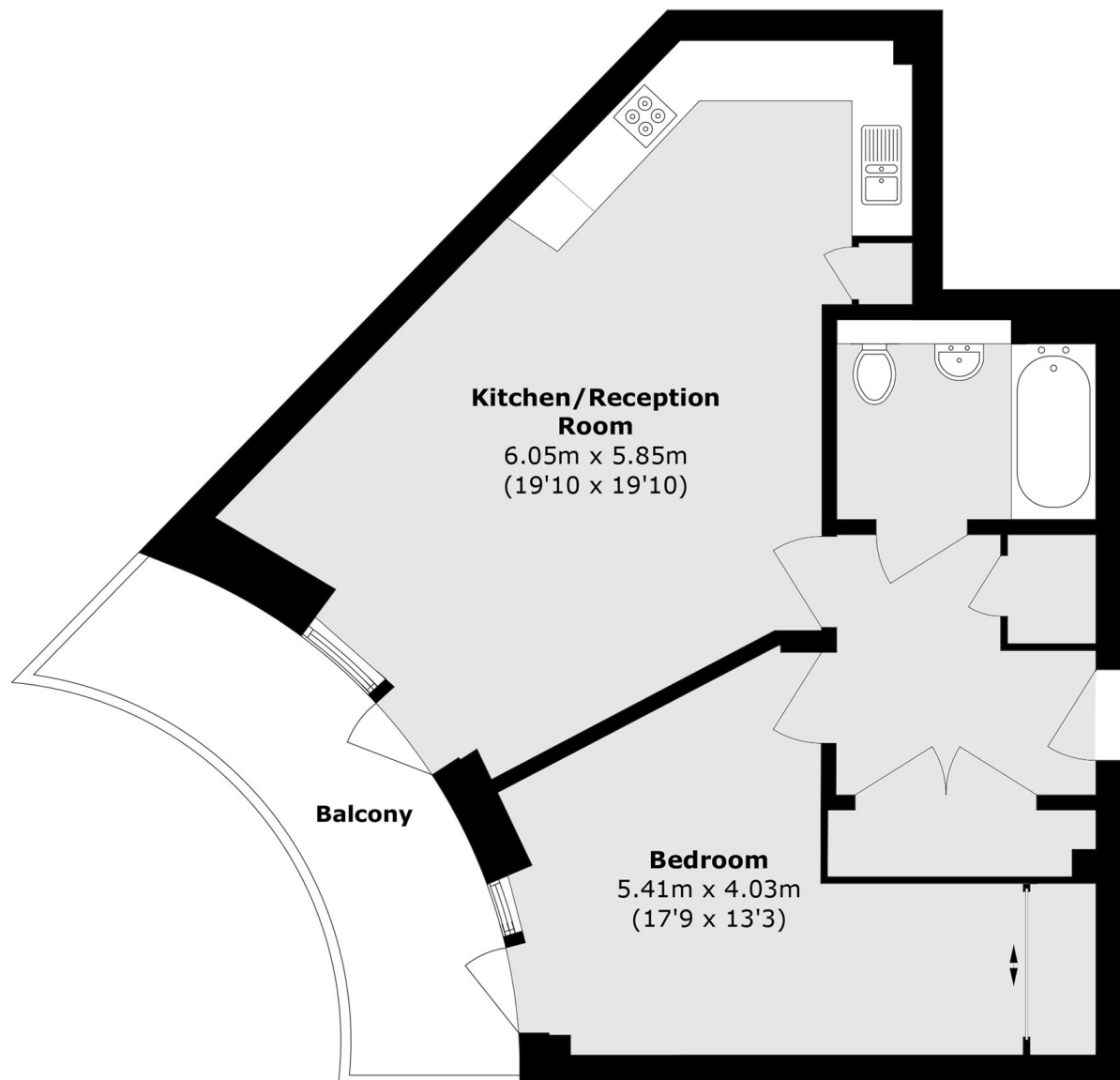

Total area (approx.): 60.1 sq. m (646.9 sq. ft)

Balcony area (approx.): 9.3 sq. m (100.1 sq. ft)