



Chevening Road, NW6

£392 Per week

A raised-ground floor one-bedroom apartment perfect for a single professional or a couple. The flat is finished to a good standard and has a spacious open-plan reception room, a modern bathroom and a good sized double bedroom.

Chevening Road is close to Queens Park offering and local transport on the Bakerloo line or London Overground at Kensal Rise.

Features

- Period Conversion
- Raised Ground Floor
- Open-plan Reception
- One Double Bedroom
- Modern Bathroom
- Great Location

Chevening Road, London, NW6

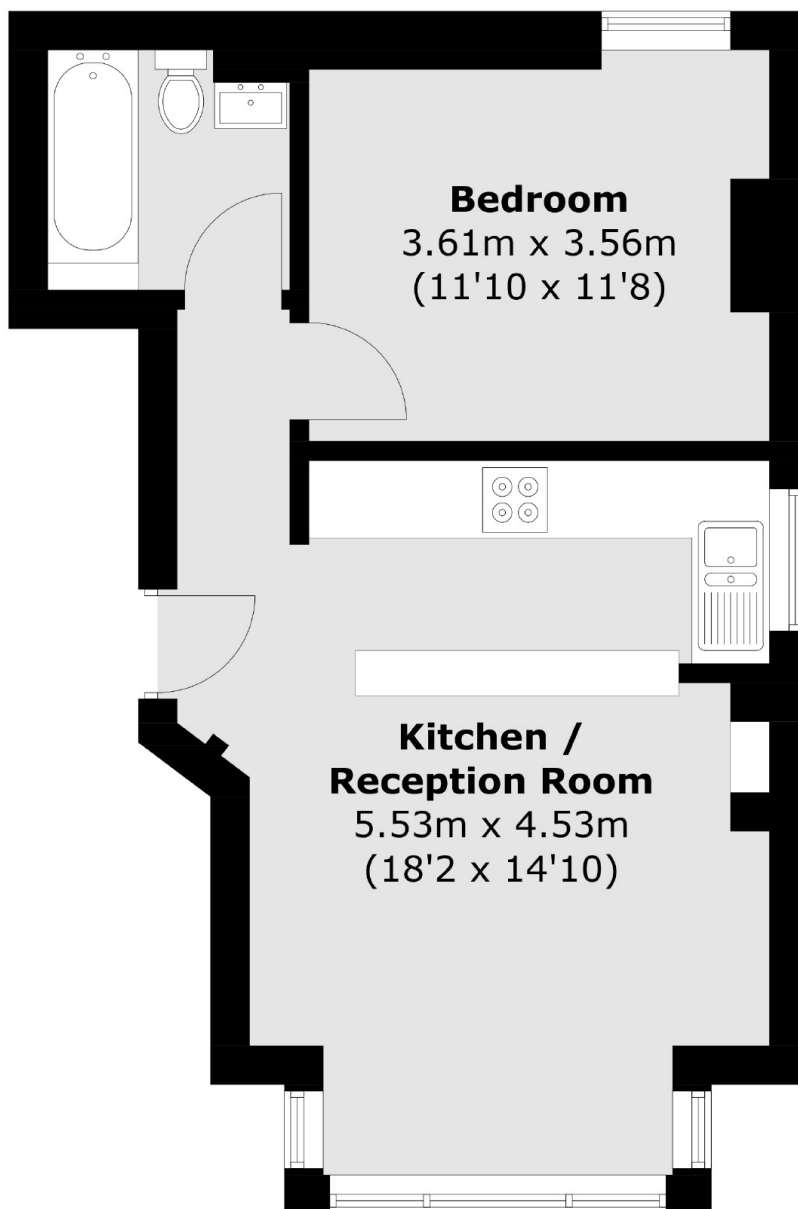

Total area (approx.): 38.7 sq. m (416.6 sq. ft)

Dexters

Kensal Rise & Queen's Park
62 Chamberlayne Road
London
NW10 3JJ
Lettings
020 8600 3101

Energy Rating: D. We aim to make our particulars both accurate and reliable. However they are not guaranteed; nor do they form part of an offer or contract. If you require clarification on any points then please contact us, especially if you're traveling some distance to view. Please note that appliances and heating systems have not been tested and therefore no warranties can be given as to their good working order.

 **RICS** | Regulated
Estate Agent
and Letting Agent

[dexters.co.uk](https://www.dexters.co.uk)