

## Priory Park Road, NW6

### £575,000

A light and spacious two double flat on the fourth floor with lift access, and set in a secure modern development. The property has an open plan full integrated kitchen and reception room, built-in storage, in excellent condition throughout, and has access to allocated gated parking.

Kyle House is located on Priory Park Road which is a tree-lined street close to the shops, cafes, and amenities on Salusbury Road, the High Road, with West Hampstead and the green open spaces of Queen's Park close by. Transport links include Queen's Park (Barkerloo & Overground), Kilburn (Jubilee), and Kilburn High Road (Overground).

### Features

- Two Double Bedrooms
- Open Plan Kitchen & Reception
- Secure Modern Development
- Share Of Freehold
- Lift
- Allocated Off-Street Parking

# Priory Park Road, London, NW6

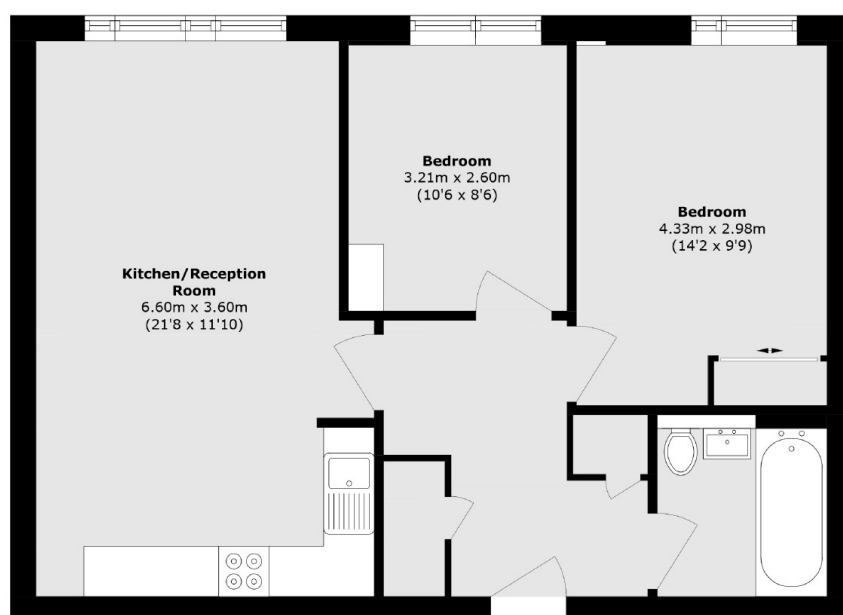

Total area (approx.): 62.0 sq. m (667.3 sq. ft)