



Glynfield Road, NW10

£461 Per week

A modern two bedroom apartment set on the ground floor of an impressive period conversion with a private garden. The property benefits from a dine in kitchen, generous reception, private entrance and wooden flooring.

Glynfield Road is a popular street located near to Roundwood Park and close to nearby shops, cafes, and restaurants in both Harlesden and Willesden. Transport links include Dollis Hill(Jubilee) and Harlesden(Bakerloo & Overground).

Features

- Two Double Bedrooms
- Own Entrance
- Private Garden
- Newly Refurbished
- Close To Roundwood Park
- Ground Floor

Glynfield Road, London, NW10

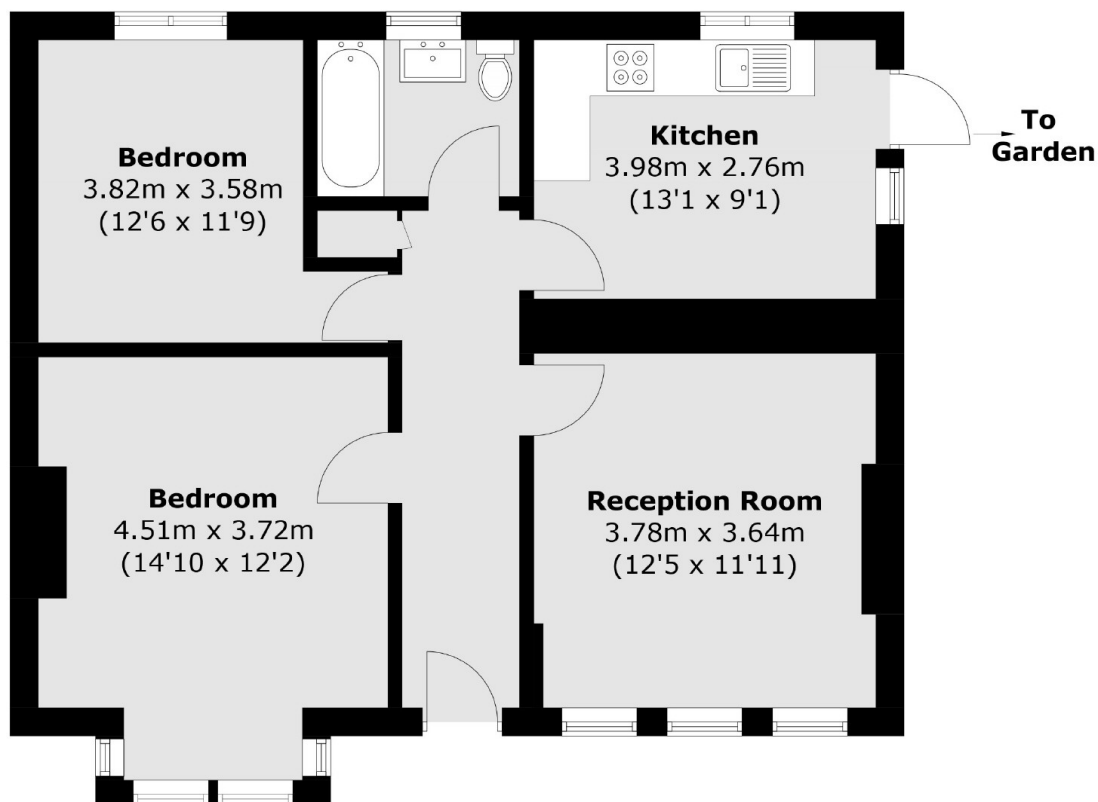

Total area (approx.): 65.1 sq. m (700.7 sq. ft)