



## Priory Park Road, NW6

### £585,000

A beautifully presented two-bedroom first-floor flat within a charming period conversion. Featuring high ceilings and abundant natural light throughout, the property boasts a bright reception room with a bay window leading to a separate kitchen. Both bedrooms include ample fitted storage.

Priory Park Road benefits from excellent transport links, with Queen's Park (Overground & Bakerloo Line), Kilburn (Jubilee Line), and Kilburn High Road (Overground) stations all within 0.6 miles. Each location also offers a variety of local amenities.

### Features

- First Floor Flat
- Two Bedrooms
- South-Facing Reception
- Separate Kitchen
- High Ceilings
- Close to Transport

# Priory Park Road, London, NW6

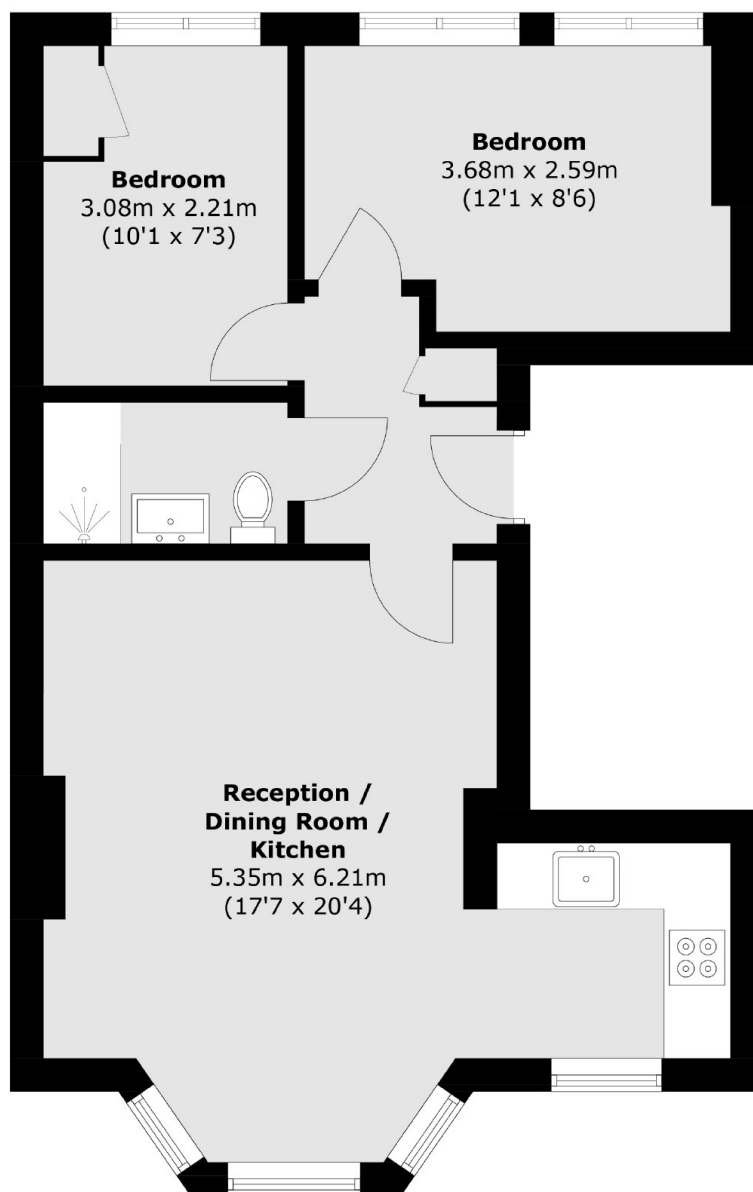

Total area (approx.): 49.4 sq. m (531.7 sq. ft)