



Harlesden Road, NW10

£461 Per week

A spacious ground floor two bedroom apartment with wooden floors. The property has a modern eat-in kitchen, good storage in the hallway as well as walk in storage in the bedroom.

Harlesden Road is next to Roundwood Park, nestled between Kensal Rise and Willesden Green. Transport links include Willesden Junction and Willesden Green stations.

Features

Two Bedrooms
Modern
Spacious
Good Condition
Ground Floor
Wooden Floors

Harlesden Road, London, NW10

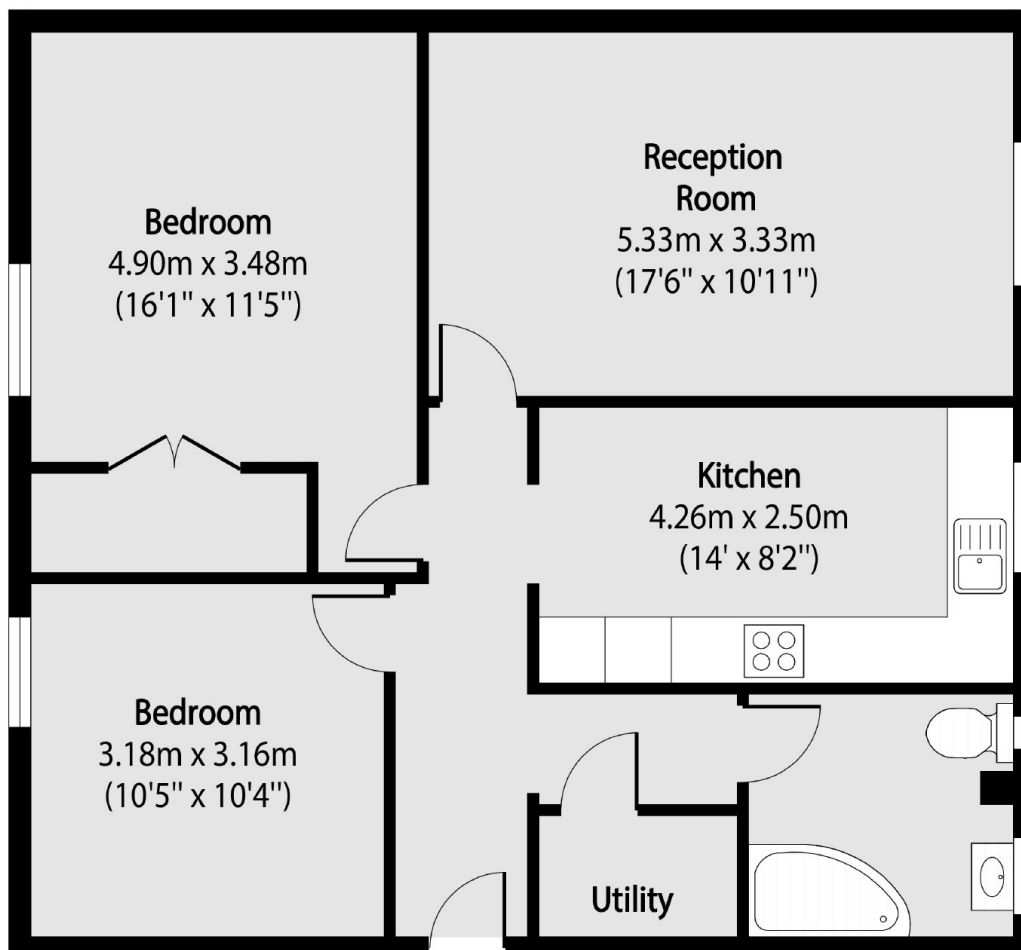

Total area (approx): 72.98 sq m (786 sq. ft)