



Curzon Crescent, NW10

£390,000

Situated in a contemporary residential development with lift access, this stunning one-bedroom flat on the second floor boasts a stylish open-plan living and a private balcony.

Curzon Crescent is conveniently located near the green spaces of the ever-popular Roundwood Park, with links to Dollis Hill (Jubilee Line) and Willesden Junction (Overground) Stations and the amenities of Willesden High Road.

Features

- One Bedroom
- New Build
- Leasehold
- Chain Free
- Excellent Condition
- Close to Roundwood Park

Curzon Crescent, London, NW10

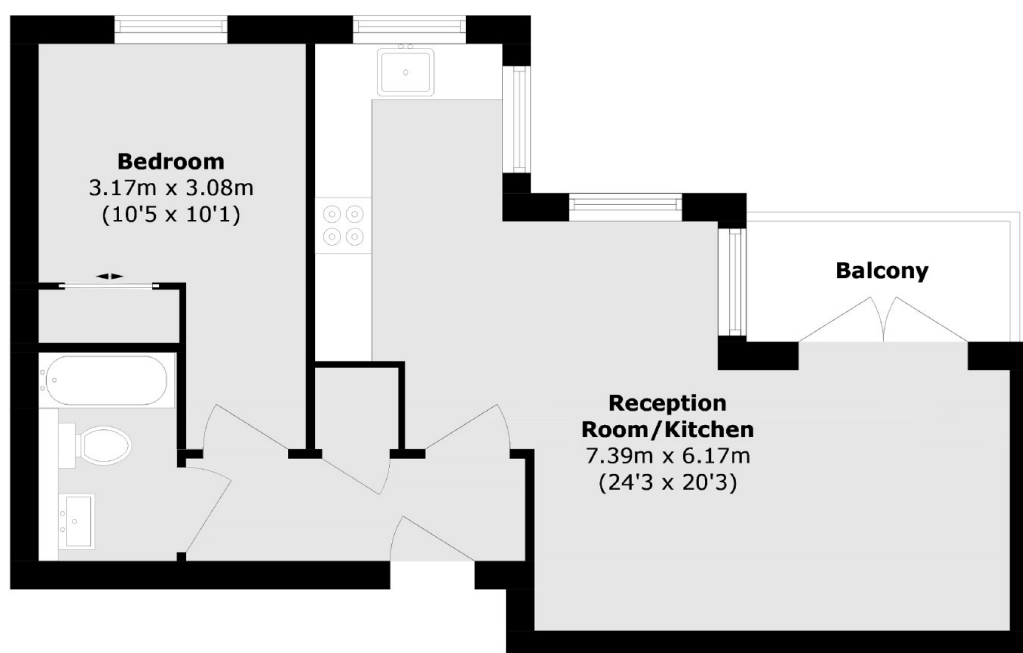

Total area (approx.): 45.5 sq. m (489.7 sq. ft)
Balcony area (approx.): 3.5 sq. m (37.6 sq. ft)