

Greyhound Road, NW10

£1,096 Per week

This beautifully presented four bedroom house is based in the heart of Kensal Rise. The property has a double reception room that leads onto the eat in kitchen that has direct access to the private garden.

Greyhound Road is located in the heart of Kensal Green with excellent transport links including a two minute walk to the tube station. The house is also in the catchment area for the best local schools. Other local amenities include coffee shops, parks, cinema and restaurants.

Features

- Four Bedroom House
- Two Bathrooms
- Utility Room
- Private Garden
- Eat in Kitchen
- Wooden Floors

Greyhound Road,
London, NW10

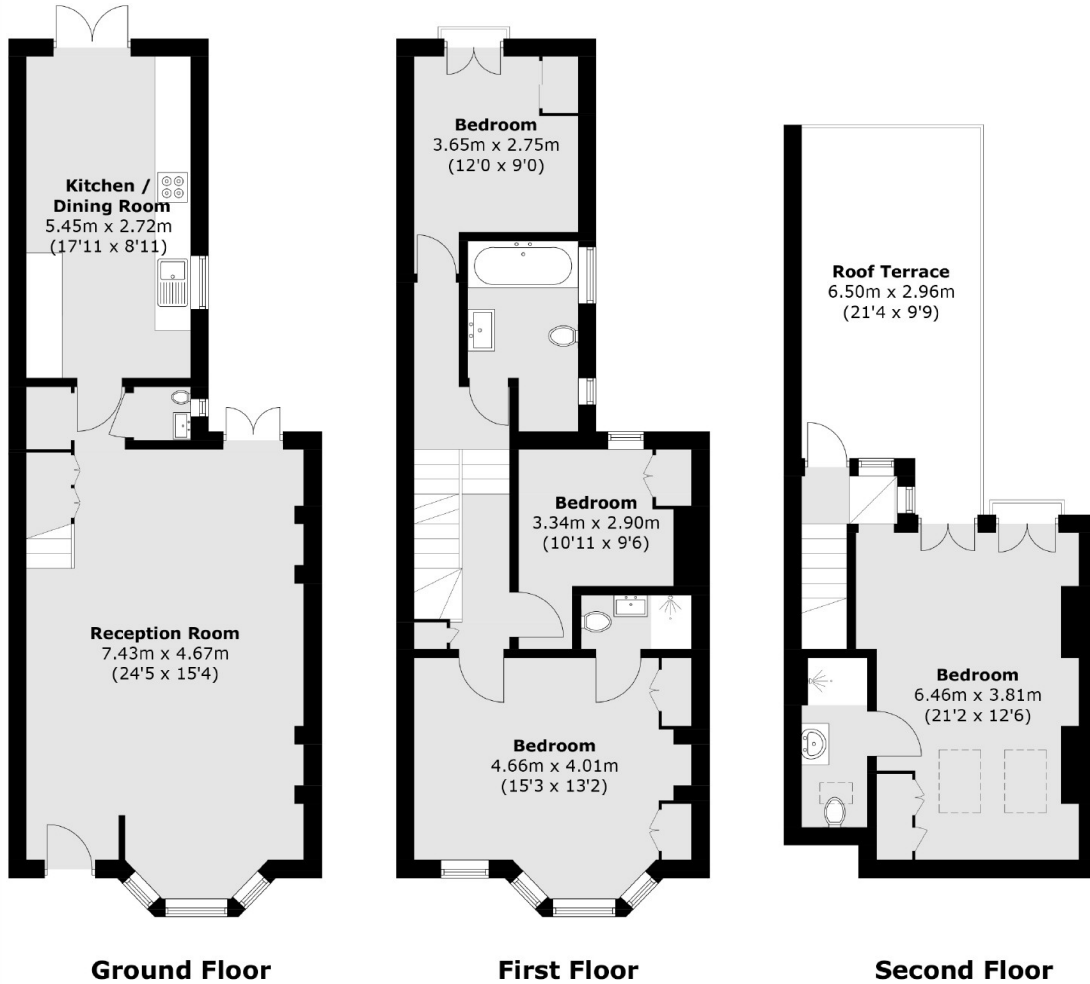

Total area (approx.): 130.2 sq. m (1,401.4 sq. ft)
Balcony area: 17.7 sq. m (190.5 sq. ft)