



Beaconsfield Road, NW10

£634 Per week

A spacious four bedroom house with two bathrooms and an eat in kitchen. Arranged over three floors, the property is within easy reach of Dollis Hill and Neasden underground stations and would be ideal for sharers or a family.

Close to Roundwood Park, the property has easy access to local shops and good transport links in to central London.

Features

- Four Bedrooms
- Two Bathrooms
- Garden
- Spacious House
- Close To Transport

Beaconsfield Road,
London, NW10

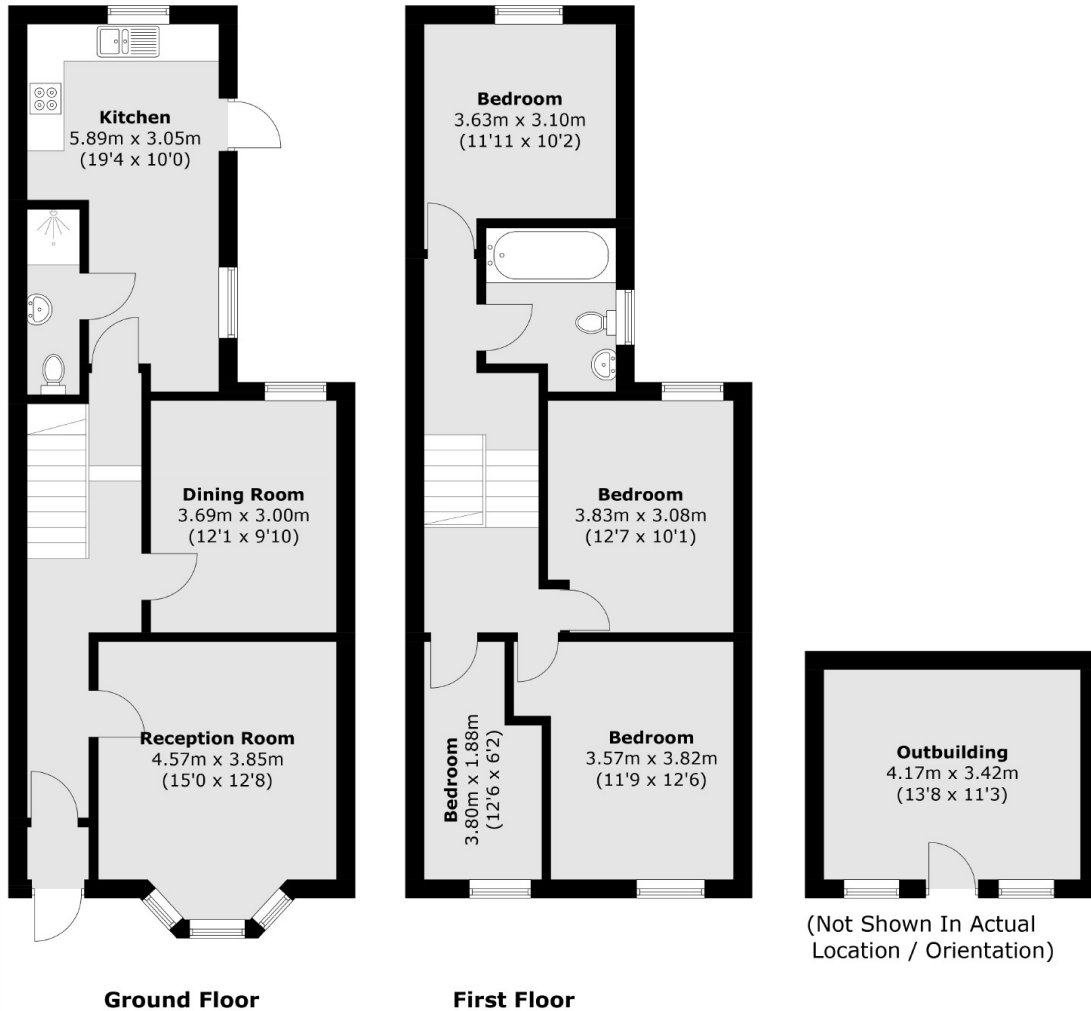

Total area (approx.): 116.7 sq. m (1,256.2 sq. ft)
Outbuilding: 14.2 sq. m (152.8 sq. ft)