



Plough Close, NW10

£415 Per week

Set within a modern development with secure access is this one bedroom flat on the first floor with three balconies. The property provides a larger living space due to its configuration on the corner of the building with natural light throughout due to its dual aspect.

Ainsworth Court is a tree-lined development, with access to local amenities in Kensal Rise, Queen's Park, Notting Hill and Shepherd's Bush. Transport links include Kensal Green (Bakerloo & Overground) and Willesden Junction (Bakerloo & Overground).

Features

- One Bedroom
- First Floor Flat
- Three Balconies
- Semi Open Kitchen & Reception
- Close to Local Amenities
- Modern

Plough Close,
London, NW10

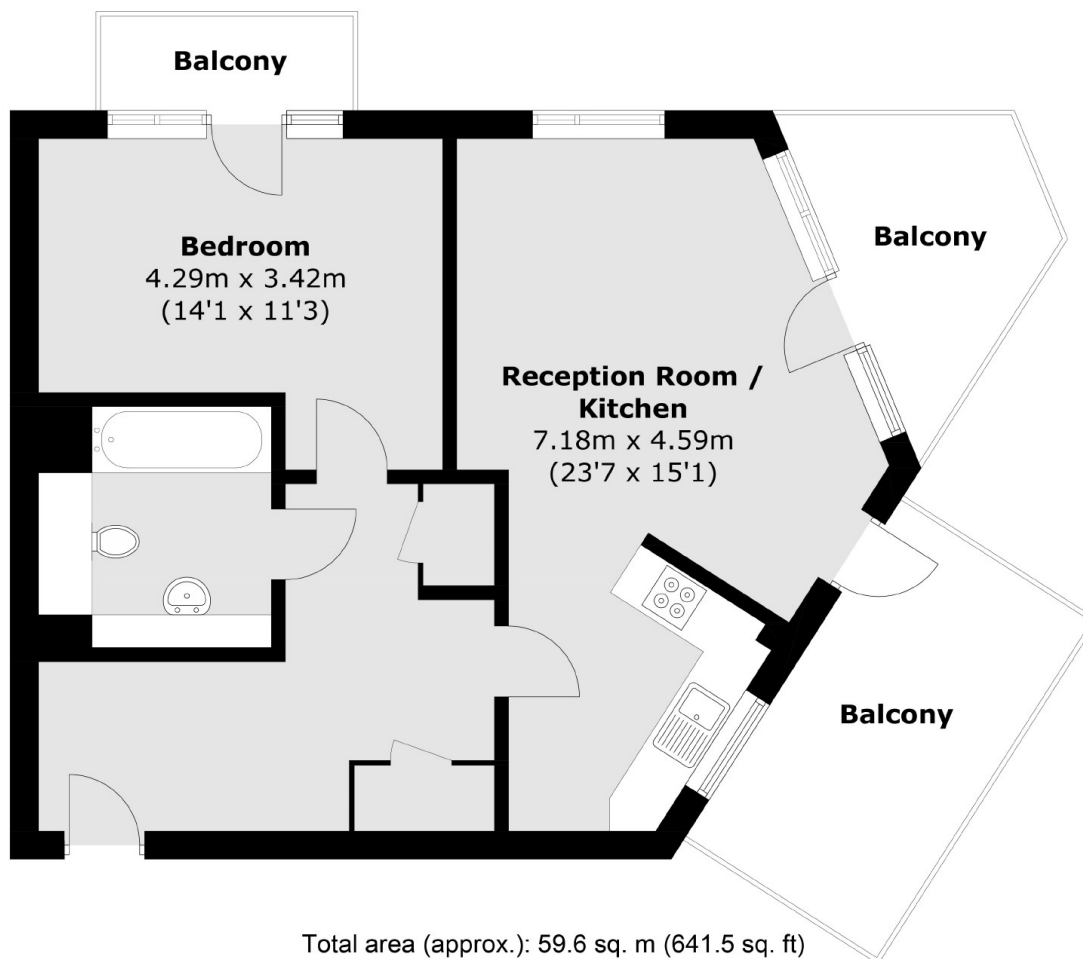

Total area (approx.): 59.6 sq. m (641.5 sq. ft)
Balcony area: 19.1 sq. m (205.5 sq. ft)