



Minet Gardens, NW10

£825,000

A spacious four double bedroom end of terrace family house, with a secure side access through to the large private garden. The property benefits from having two reception rooms, a separate eat-in kitchen and utility room to the rear, high ceilings throughout, and has the potential to be extended further.

Minet Gardens is a tree-lined quiet residential street and a no through road, located close to the shops and local amenities on Harlesden High Street. Transport links includes Willesden Junction(Bakerloo & Overground) and Harlesden(Bakerloo & Overground) and numerous bus routes.

Features

- Four Double Bedrooms
- Three Bathrooms
- Separate Eat-In Kitchen
- Two Reception Rooms
- Utility Room
- Close To Transport Links

Minet Gardens, London, NW10

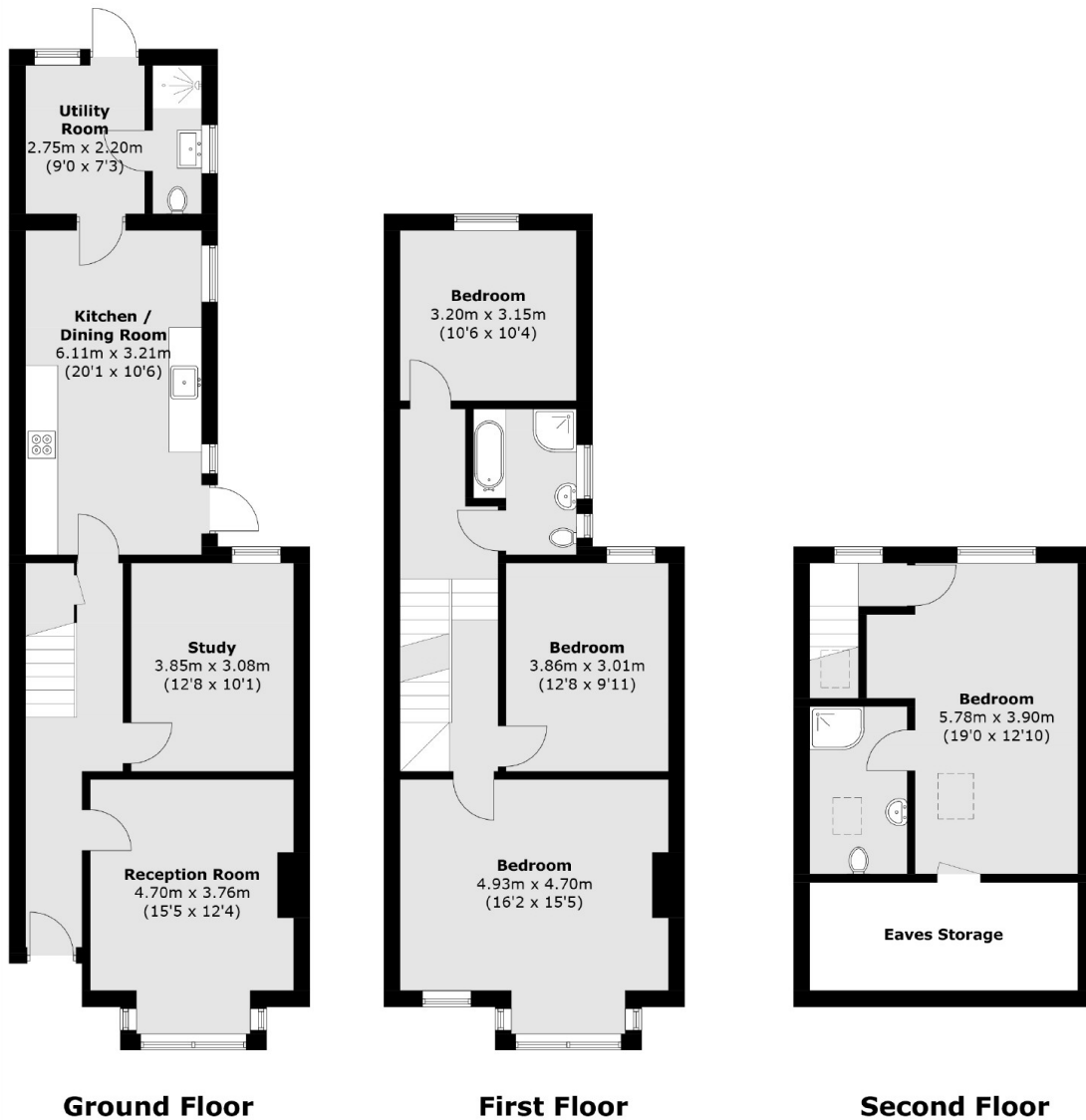

Total area (approx.): 159.4 sq. m (1,715.7 sq. ft)
(Excluding Eaves Storage)