



Ilbert Street, W10

£430,000

A well presented light and spacious two double bedroom first floor flat in a secure purpose built block. The property benefits from having a separate kitchen, a west facing balcony, ample storage throughout, and in a sought-after location.

Queens Park Court is located in a quiet residential area next to Queens Park Conservation Area, with access to the shops, cafes, restaurants and bars on Chamberlayne Road. Transport links include Kensal Rise (Overground) and Kensal Green (Bakerloo & Overground).

Features

- Two Bedrooms
- Separate Kitchen
- Balcony
- Off-Street Parking
- Ample Storage
- Great Location

Ilbert Street, London, W10

First Floor

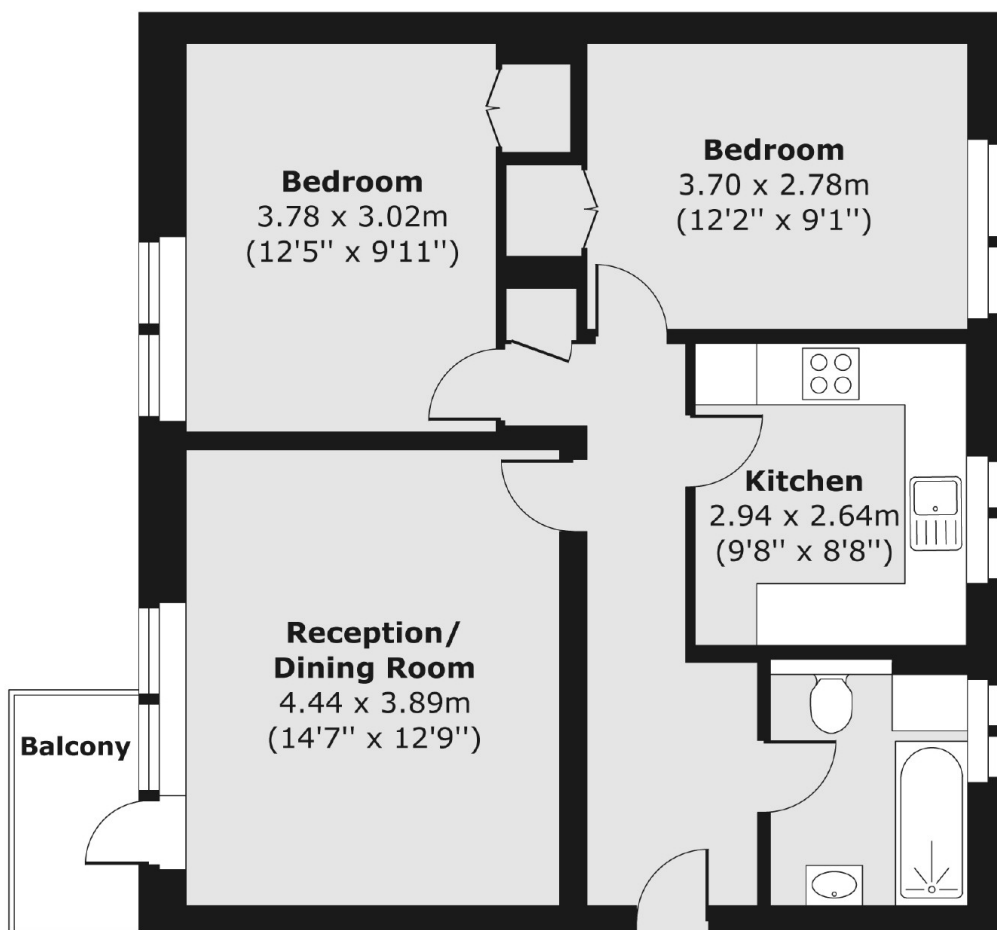

Total area (approx.) 63.92 sq. m (688 sq. ft)
Balcony area (approx.) 2.78 sq. m (30 sq. ft)