



## Sidmouth Parade, NW2

### £350,000

Flooded with natural light is this two double bedroom top floor flat in a popular purpose built block. The property benefits from having a separate kitchen, is in good condition throughout, available chain-free, and is close to local amenities.

Sidmouth Road is a residential street close to the shops, cafes, restaurants and bars in both Queen's Park and Willesden Green. Transport links include Willesden Green (Jubilee), Brondesbury Park (Overground), and Queen's Park (Bakerloo & Overground).

### Features

- Two Double Bedrooms
- One Bathroom
- Top Floor Flat
- Separate Kitchen
- Chain-Free
- Close To Local Amenities

# Sidmouth Parade, London, NW2

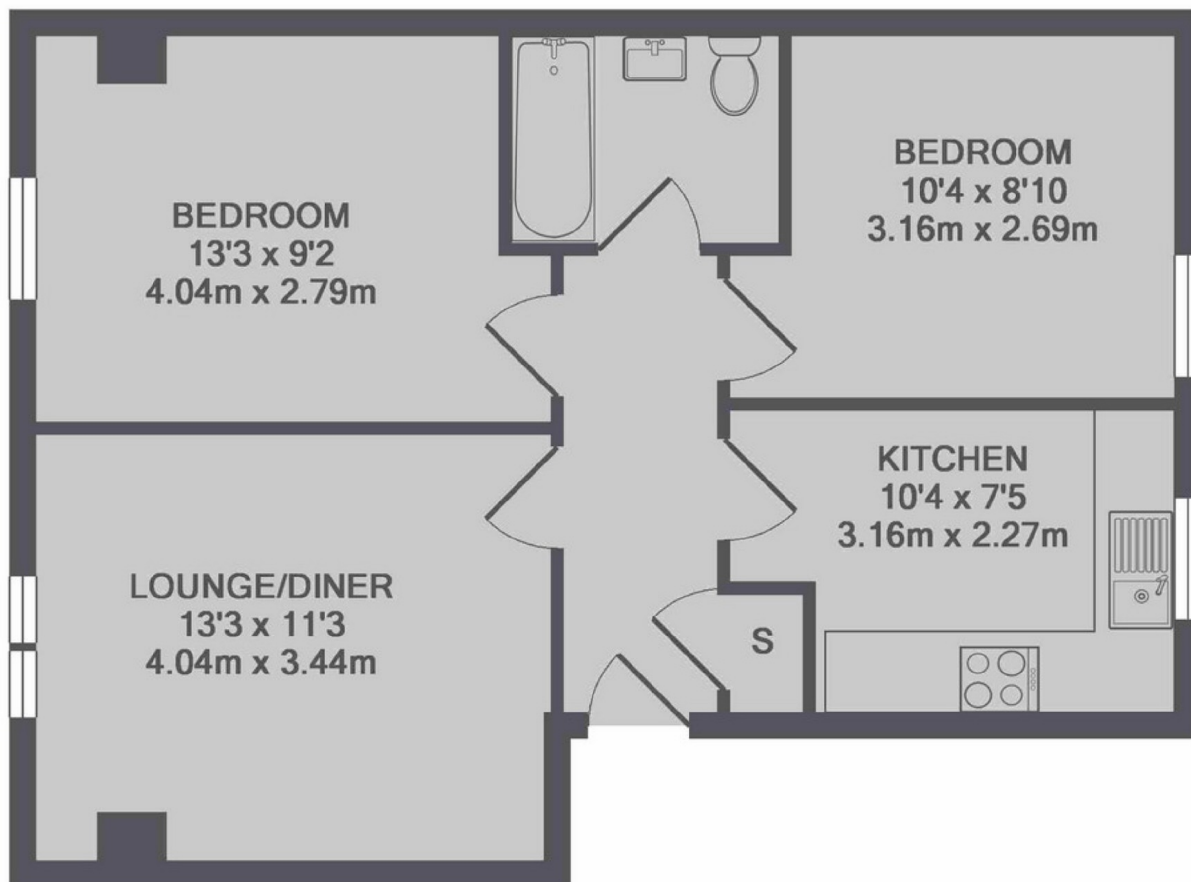

TOTAL APPROX. FLOOR AREA 544 SQ.FT. (50.5 SQ.M.)