



Springwell Avenue, NW10

£1,100,000

A fantastic opportunity to acquire a five bedroom mid terraced house, having recently been extended into the roof space allowing for two additional bedrooms both with en suites, though it could be extended further on the ground floor. The property is requiring a finished touched throughout, providing a great opportunity for a buyer not wanting to complete structural works.

Springwell Avenue is a tree-lined street near to Roundwood Park, and in close proximity to Harlesden High Street and Willesden, with access to shops, cafes, bars and restaurants. Transport links include Willesden Junction (Bakerloo & Overground) and Harlesden (Bakerloo) along with multiple bus routes.

Features

- Freehold
- Five Bedrooms
- Four Bathrooms & WC
- Double Reception Room
- South West Facing Garden
- Chain-Free

Springwell Avenue, London, NW10

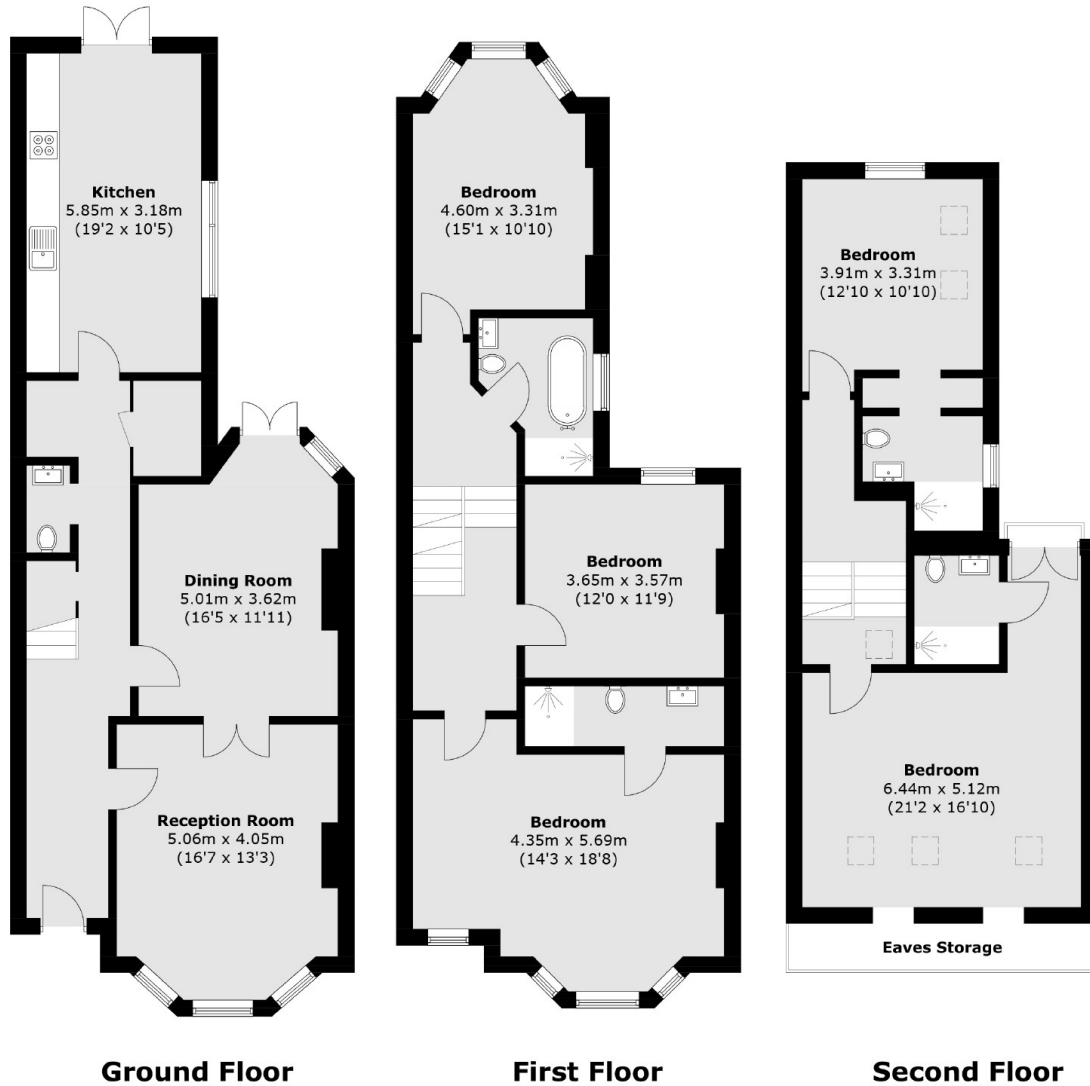

Total area (approx.): 207.2 sq. m (2230.3 sq. ft)
(Excluding Eaves)