

Kimberley Road, NW6

£650,000

A spacious two double bedroom first floor flat in a modern development with lift access and secure gated parking. The property benefits from having a large reception room and a south facing balcony, a separate kitchen, is available chain-free, and located in Queen's Park.

Kimberley Court is a development located off Willesden Lane, and in close proximity to the shops, cafes, and amenities on Salusbury Road, and the green open spaces of Queen's Park. Transport links include Brondesbury Park (Overground), Queen's Park (Bakerloo & Overground), and Kilburn (Jubilee).

Features

- Two Double Bedrooms
- Large Reception Room
- South Facing Balcony
- Lift
- Secure Gated Parking
- Chain-Free

Kimberley Road, London, NW6

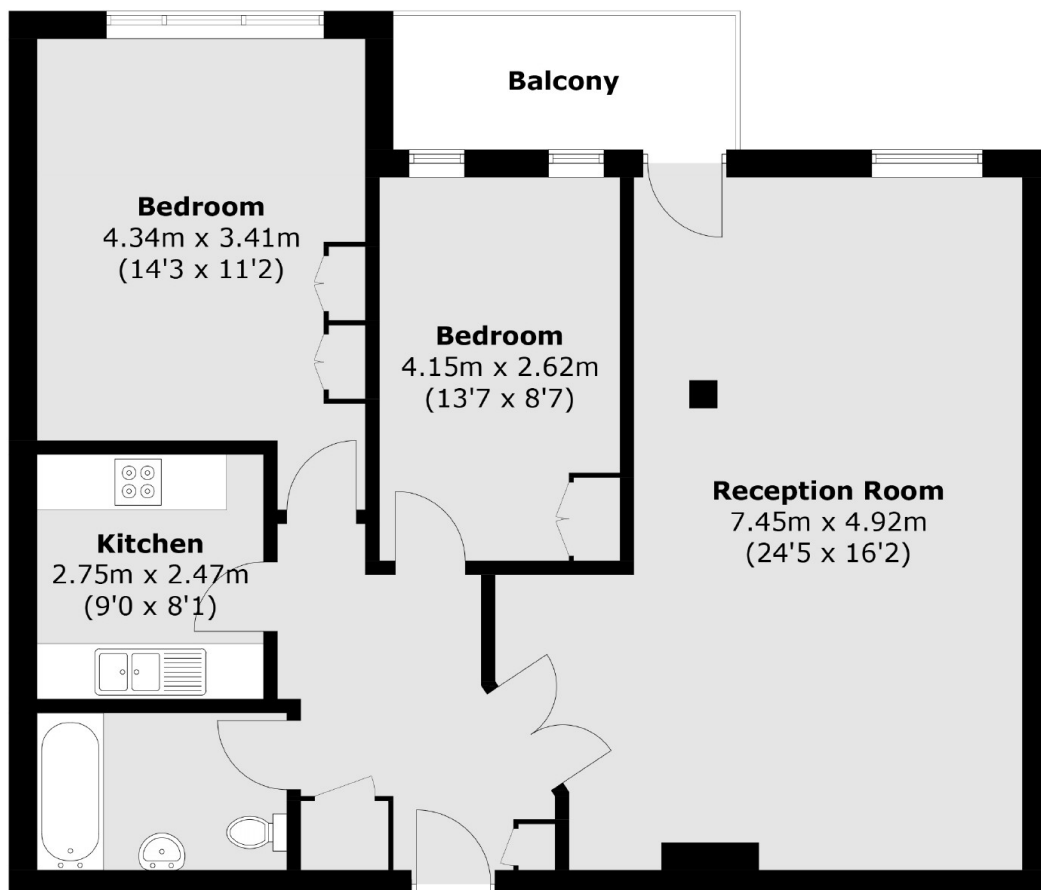

Total area (approx.): 85.5 sq. m (920.3 sq. ft)
Balcony: 5.4 sq. m (58.1 sq. ft)