



Purves Road, NW10

£999,950

An opportunity to acquire a five bedroom mid terrace Victorian house, arranged over three floors, with the added potential to be extended further, and available chain-free.

Purves Road is a residential street located close to the shops, cafes, and amenities on College Road and Chamberlayne Road, with the green open spaces of Queen's Park nearby. Transport links include Kensal Green (Bakerloo & Overground) and Kensal Rise (Overground) and multiple bus routes.

Features

- Freehold
- Five Bedrooms
- Three Bathrooms
- Potential To Extend
- Chain-Free
- Close To Transport Links

Purves Road, London, NW10

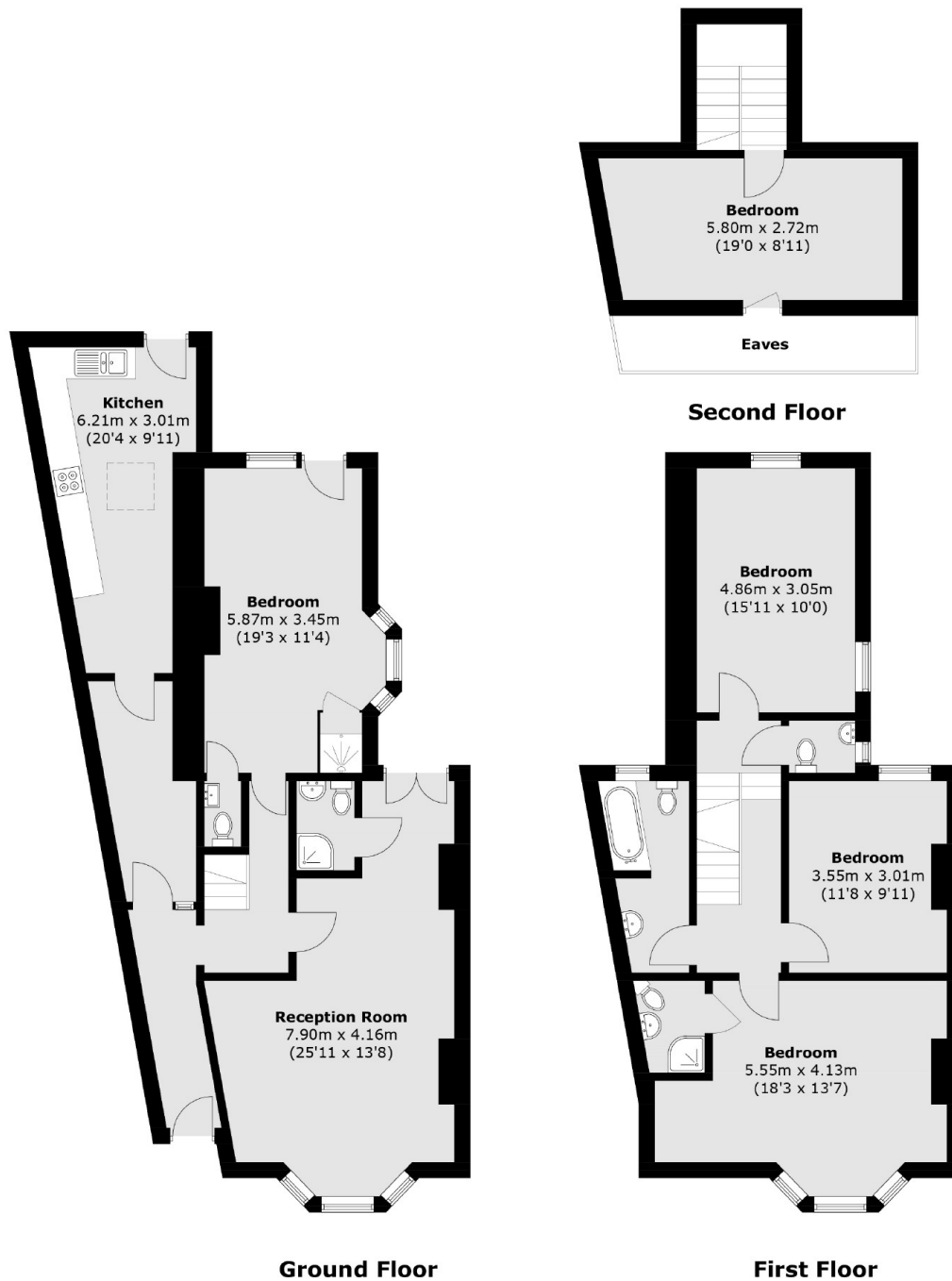

Total area (approx.): 166.0 sq. m (1,786.7 sq. ft)
(Excluding Eaves)