



Sidmouth Parade, NW2

£325,000

A two double bedroom top floor flat in a popular purpose built block which is flooded with natural light, and has an impressive rear view across London. The property benefits from having a separate kitchen, is well presented throughout, and is close to local amenities.

Sidmouth Road is a residential street close to the shops, cafes, restaurants and bars in both Queen's Park and Willesden Green. Transport links include Willesden Green (Jubilee), Brondesbury Park (Overground), and Queen's Park (Bakerloo & Overground).

Features

- Two Double Bedrooms
- One Bathroom
- Top Floor Flat
- Separate Kitchen
- Good Condition
- Close To Local Amenities

Sidmouth Parade, London, NW2

Third Floor

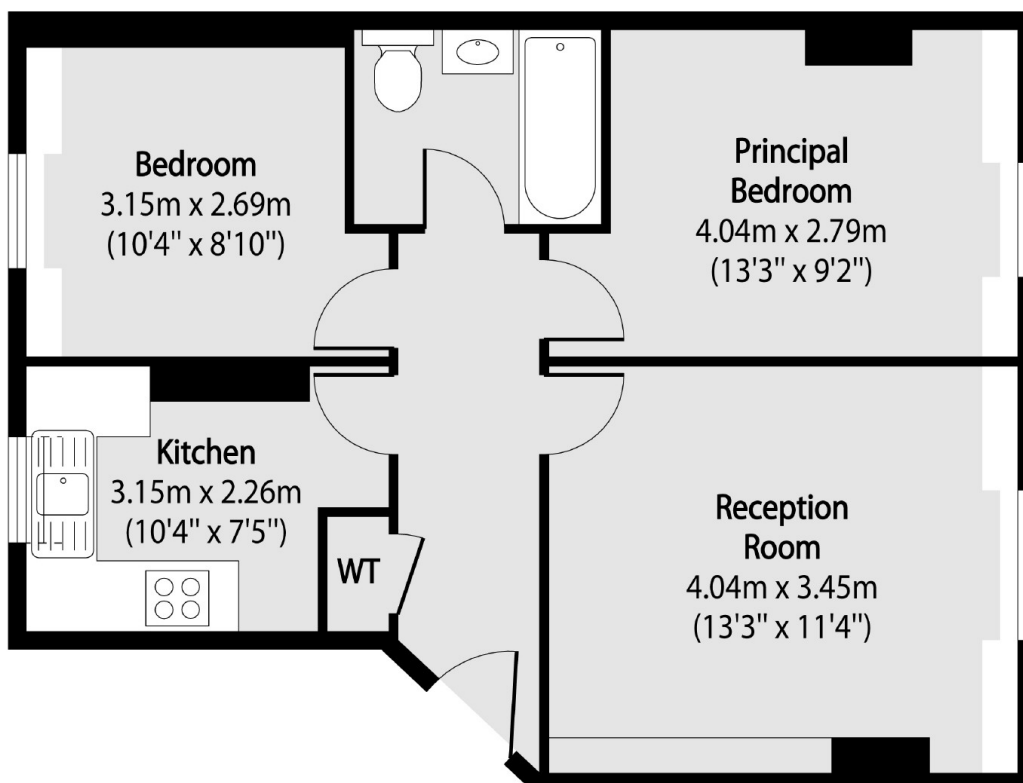

Total area (approx): 49.61 sq m (534 sq. ft)