

Cherry Drive, Ellesmere, SY12 9PF

£850

Council Tax Band: B



Nestled in the charming area of Cherry Drive, Ellesmere, this delightful cosy two-bedroom house offers a perfect blend of comfort and modern living.

The property features a well-appointed bathroom, catering to all your daily needs with ease and a nice modern kitchen. Additionally, the convenience of parking for one vehicle adds to the appeal, making this home not only practical but also accessible.

Situated in a friendly neighbourhood, this house is perfect for first-time buyers or those looking to downsize. With its modern construction and thoughtful design, it presents an excellent opportunity to own a lovely home in a desirable location. Whether you are seeking a tranquil environment or a vibrant community, this property on Cherry Drive is sure to meet your expectations. Don't miss the chance to make this charming house your new home.



Open House Whitchurch

Ground Floor

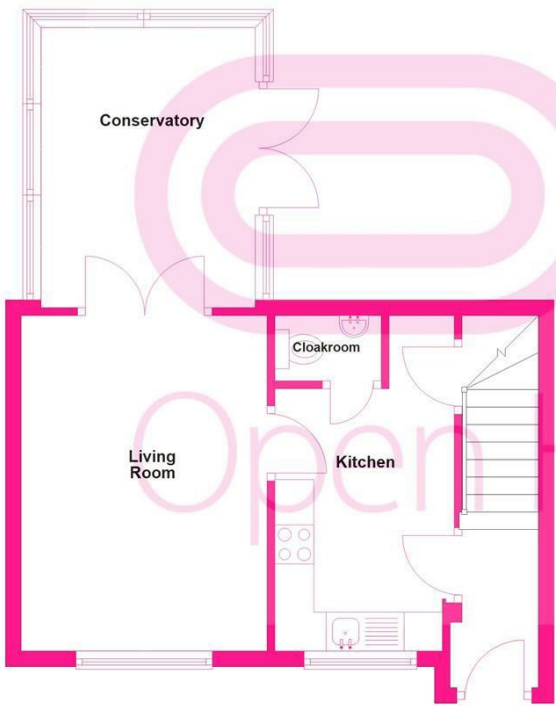

First Floor

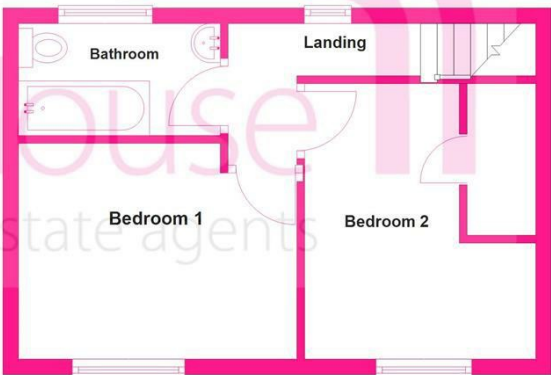

Energy Efficiency Rating		
	Current	Potential
Very energy efficient - lower running costs		
(92 plus) A		
(81-91) B		
(69-80) C		
(55-68) D		
(39-54) E		
(21-38) F		
(1-20) G		
Not energy efficient - higher running costs		
England & Wales	EU Directive 2002/91/EC	