

Lindsey Close, Portishead, Bristol, BS20 8RR

£1,500

Council Tax Band: C



Are you looking for a garden to enjoy? We are proud to present this three bedroom end of terrace property in a quiet cul-de-sac location in Portishead. The accommodation consists of a hall, lounge, kitchen/diner, three bedrooms and a bathroom. The rear garden has lawn and patio areas, mature shrubs and a green house for those with horticultural ambitions. There is off street parking for two cars.

An income of £52,000 pa is required for this property.
Full referencing and ID checks will apply.
Pets considered.
Sorry No Sharers, No Smokers.

The property is subject to band C council tax.

Rent £1500 pcm
Deposit £1730
Holding deposit £345



Open House Bristol North East

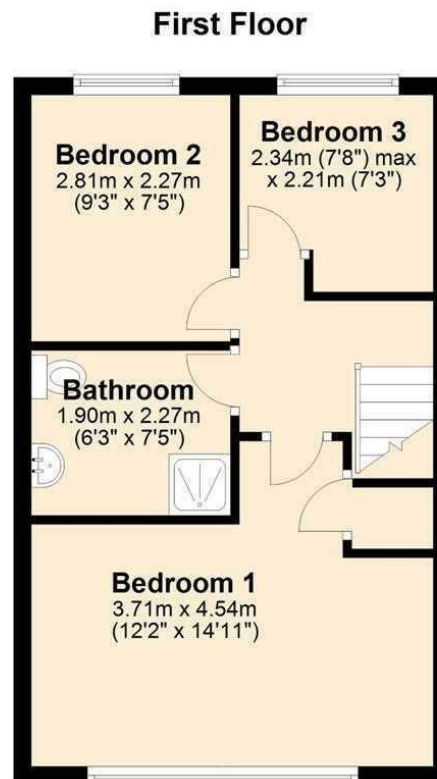
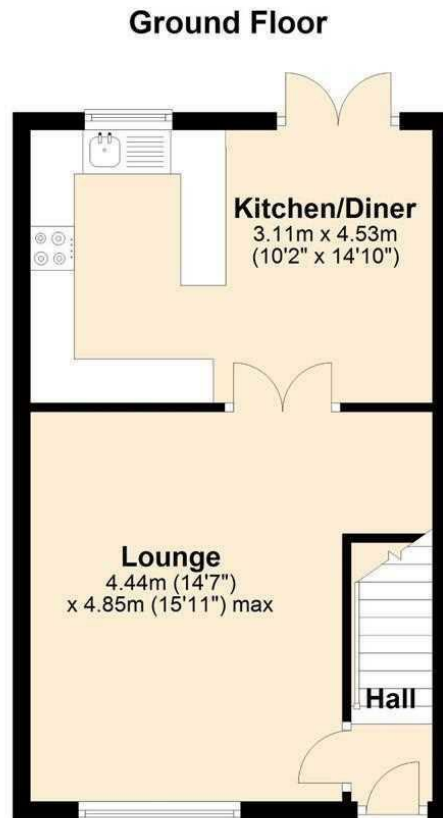

Energy Efficiency Rating		
	Current	Potential
Very energy efficient - lower running costs		
(92 plus) A		87
(81-91) B		
(69-80) C		
(55-68) D		
(39-54) E		
(21-38) F		74
(1-20) G		
Not energy efficient - higher running costs		
England & Wales		EU Directive 2002/91/EC