

Widden Street, Gloucester, GL1 4AN
£180,000

OL
Open House
estate agents



Widden Street, Gloucester, GL1 4AN

£180,000

Council Tax Band: A

Open House Gloucester is proud to present this terraced two bedroom house nestled in the charming area of Widden Street, Gloucester. This delightful mid-terrace house offers a perfect opportunity for an investment. The property boasts a rich history while providing a comfortable and inviting atmosphere for its residents.

This home features two well-proportioned reception rooms, ideal for both relaxation and entertaining. The spacious layout allows for a seamless flow between the living areas, making it perfect for family gatherings or quiet evenings in. The two bedrooms provide ample space for rest and rejuvenation, catering to both individuals and small families alike.

The property includes a well-appointed bathroom, ensuring convenience and comfort for daily routines. With its classic design and thoughtful layout, this house is a wonderful opportunity for those seeking a home with character in a vibrant community.

Widden Street is conveniently located, offering easy access to local amenities, schools, and transport links, making it an ideal choice for both first-time buyers and those looking to downsize. This charming mid-terrace house is not just a property; it is a place to create lasting memories. Don't miss the chance to make it your own.

Hallway

Living Room

10'11" x 10'7" (3.35 x 3.25)

Dining Room

7'1" x 12'11" (2.18 x 3.94)

Kitchen

9'11" x 7'6" (3.04 x 2.3)

Bedroom 1

11'0" x 14'1" (3.36 x 4.30)

Bedroom 2

10'8" x 10'0" (3.27 x 3.07)

Bathroom

10'0" x 7'6" (3.07 x 2.30)

Garden

House Front

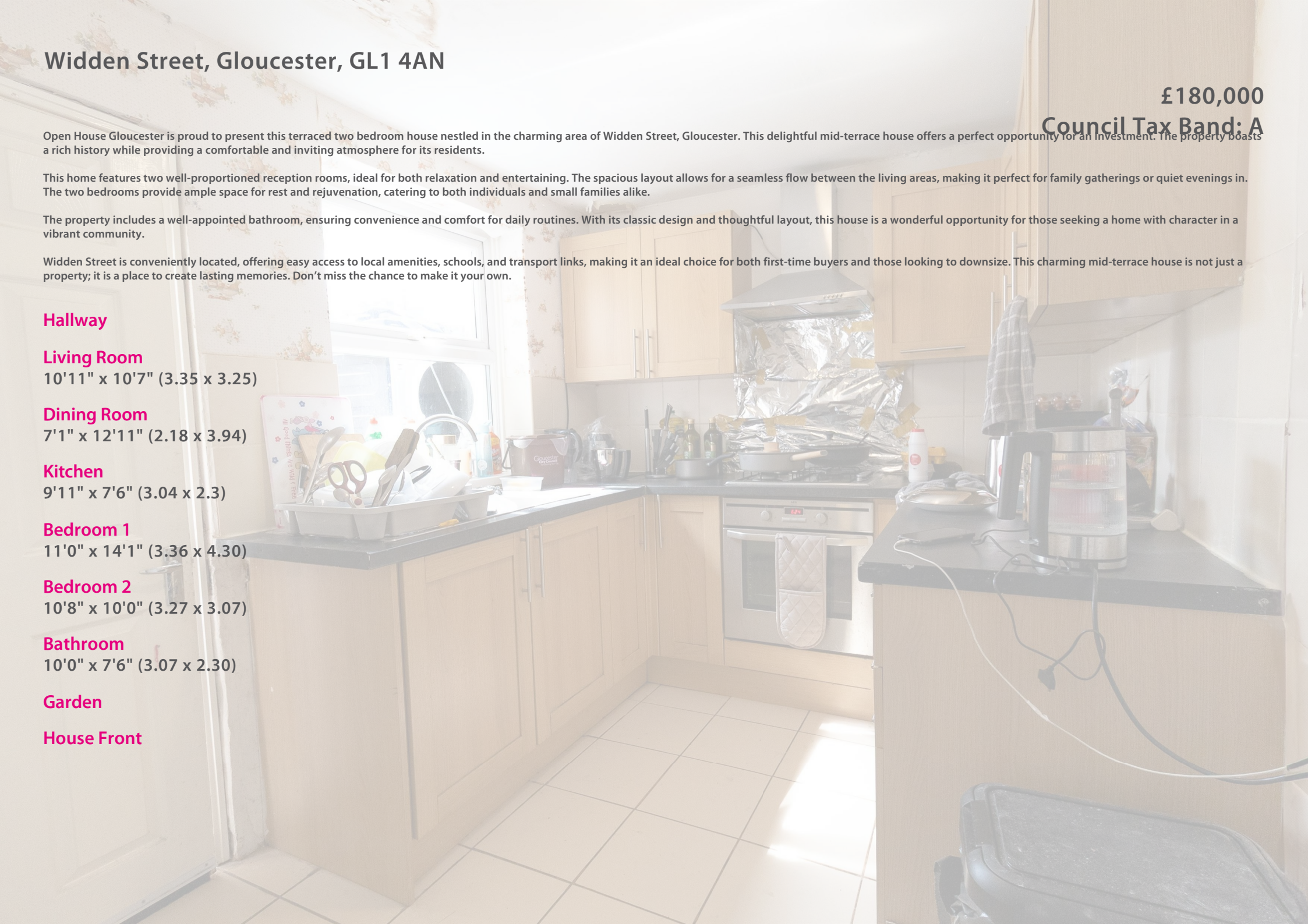



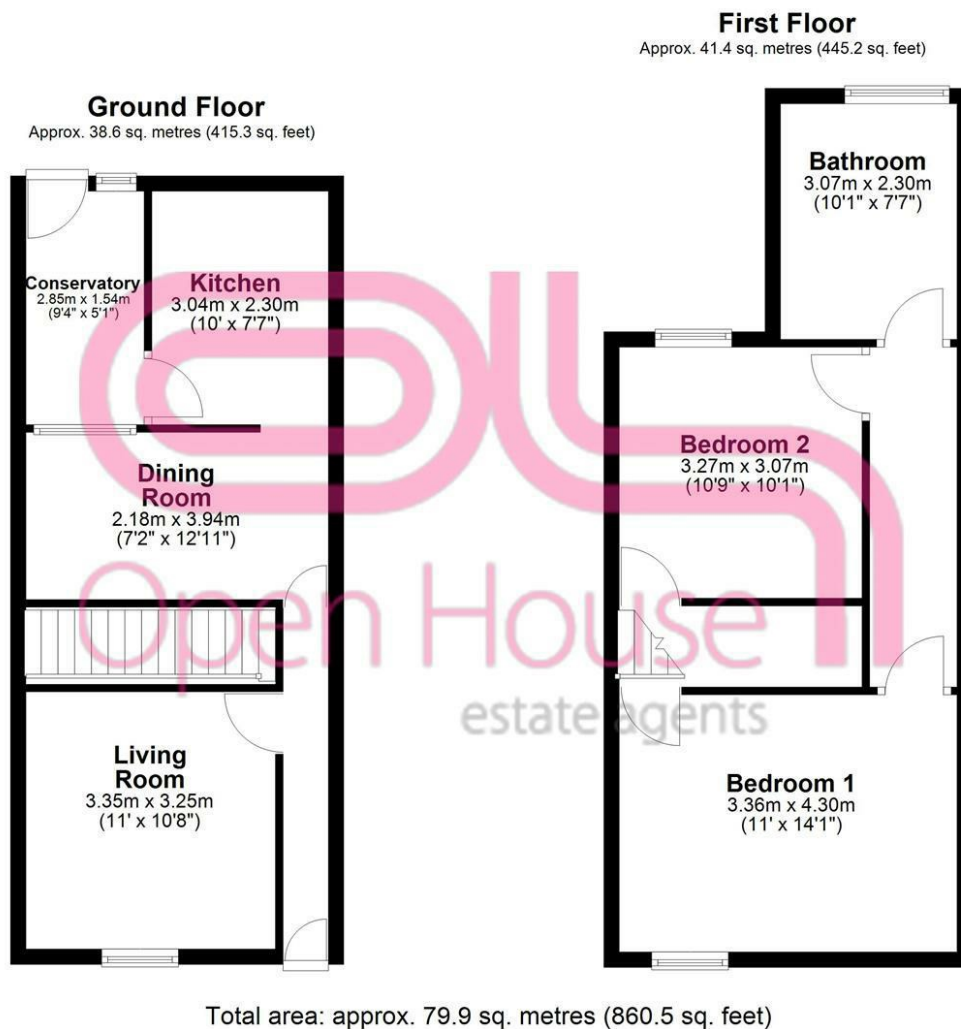

Energy Efficiency Rating		
	Current	Potential
Very energy efficient - lower running costs		
(92 plus) A		
(81-91) B		
(69-80) C		
(55-68) D		
(39-54) E		
(21-38) F		
(1-20) G		
Not energy efficient - higher running costs		
England & Wales		
EU Directive 2002/91/EC		