

Holmes Park, North Street, Horsham, West Sussex, RH12 1FA

£1,200 Per Month

Council Tax Band:



LOCATION

Open House Horsham are delighted to bring to the market this very well-presented, stylish one bedroom apartment in a highly convenient location in the centre of Horsham. Positioned opposite Horsham Park, it is less than a 5 minute walk to Horsham train station and the town centre and it is adjacent to the Capitol cinema and theatre.

PROPERTY

This modern apartment block was completed in 2019 with a mixture of studio, one and two bed apartments. Located on the second floor on the corner of the building this stylish apartment is comprised of a kitchen/living room, double bedroom and large bathroom. The kitchen has a range of base and wall units and integrated washing machine, hob, oven and fridge/freezer and free-standing slimline dishwasher. The open plan living area is flooded with light due to the large, dual aspect windows which give it a Manhattan apartment feel. The bathroom has a modern, white suite with shower over the bath. It is neutrally decorated throughout with white walls, laminate flooring, cream carpet in the bedroom and Venetian blinds at the windows. It also has underfloor heating throughout. Finally, there are lifts in the building and an intercom answering system.

OUTSIDE

There is one allocated parking space,



Open House Horsham

Floor Plan

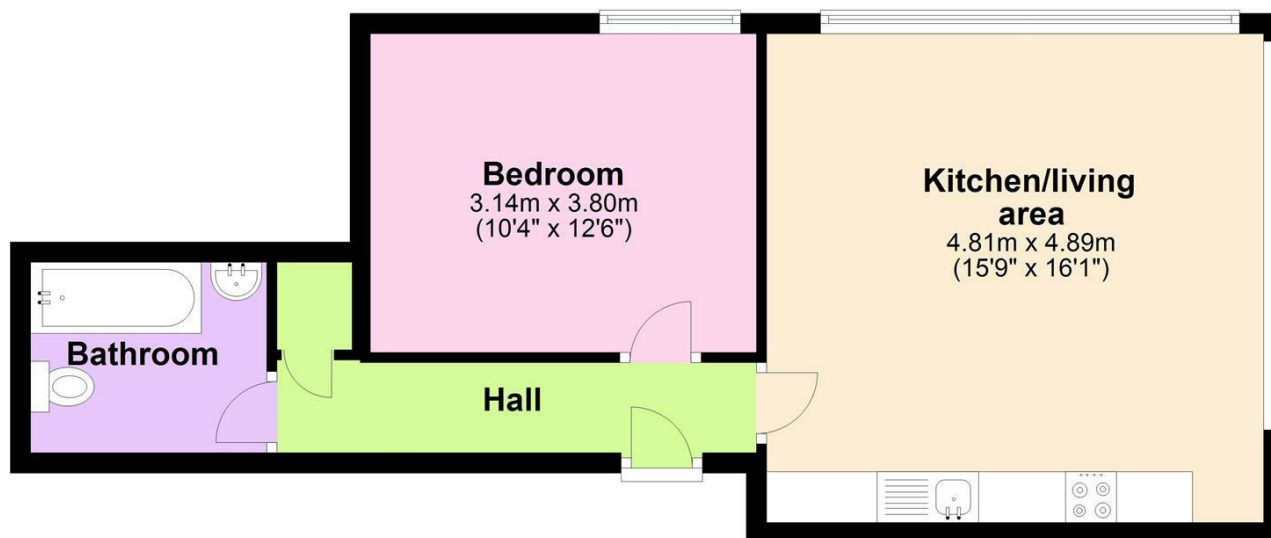

Total area: approx. 45.9 sq. metres (494.0 sq. feet)

Holmes Park



Energy Efficiency Rating		
	Current	Potential
Very energy efficient - lower running costs		
(92 plus) A		
(81-91) B		
(69-80) C		
(55-68) D	66	66
(39-54) E		
(21-38) F		
(1-20) G		
Not energy efficient - higher running costs		
England & Wales		EU Directive 2002/91/EC