

OFFERS IN THE REGION OF

**£520,000**

**School Lane**

Stafford, ST17 9JB



## PROPERTY SUMMARY

### Dream Home Alert! Extended 5-Bedroom Detached House on School Lane, Stafford

Welcome to this spectacular five-bedroom detached property, a true family dream home located on the sought-after School Lane in Stafford. Perfectly blending style, space, and convenience, this home offers an exceptional opportunity to enjoy contemporary living in a prime residential area. With outstanding local amenities and superb transport links, this property is sure to captivate.

5



4



3















LOCAL AUTHORITY

TENURE  
Freehold

COUNCIL TAX BAND  
F

VIEWINGS  
By prior appointment only

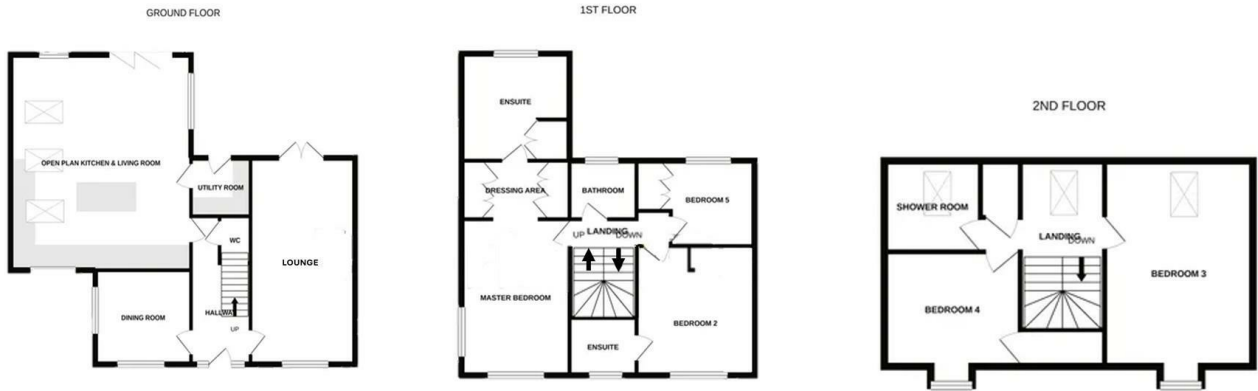

| Energy Efficiency Rating                    |                         |           |
|---|-------------------------|-----------|
|   | Current                 | Potential |
| Very energy efficient - lower running costs |                         |           |
| (92 plus) A                                 |                         |           |
| (81-91) B                                   |                         |           |
| (69-80) C                                   |                         |           |
| (55-68) D                                   |                         |           |
| (39-54) E                                   |                         |           |
| (21-38) F                                   |                         |           |
| (1-20) G                                    |                         |           |
| Not energy efficient - higher running costs |                         |           |
| England & Wales                             | EU Directive 2002/91/EC |           |

Agents Note: Whilst every care has been taken to prepare these particulars, they are for guidance purposes only. All measurements are approximate and are for general guidance purposes only and whilst every care has been taken to ensure their accuracy, they should not be relied upon and potential buyers/tenants are advised to recheck the measurements