

The Clockmakers Cottage, Lower Church Street, Ashby-De-La-Zouch,
LE65 1AB
£600,000



This property is currently running as an established BnB business with 3 bedrooms, separated from the 2-bedroom residential section. Both sides of the property are on the same title. The layout is perfect for its current usage, though the property could also make an especially spacious 5-bedroom home in a beautiful location.



Open House Burton & Swadlincote

Lower Church Street, Ashby-de-la-Zouch

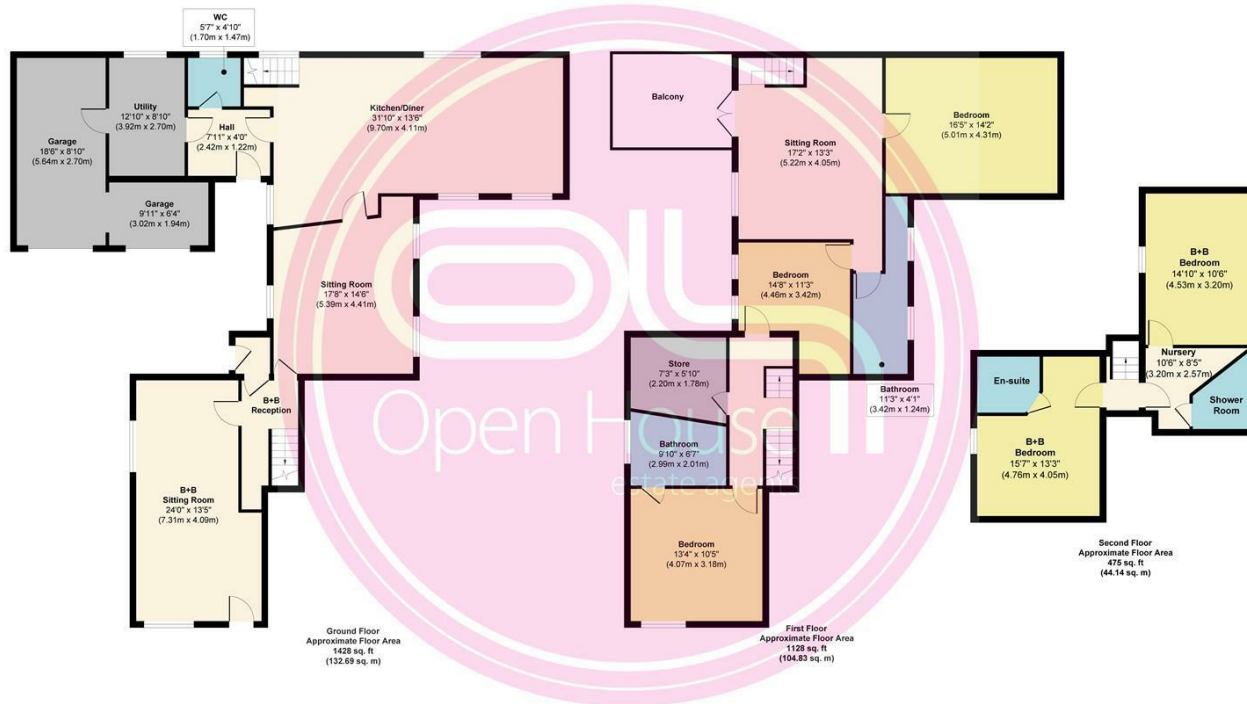

| Energy Efficiency Rating | | |
|---|---------|-------------------------|
| | Current | Potential |
| Very energy efficient - lower running costs | | |
| (92 plus) A | | |
| (81-91) B | | |
| (69-80) C | | |
| (55-68) D | 55 | |
| (39-54) E | | |
| (21-38) F | | |
| (1-20) G | | |
| Not energy efficient - higher running costs | | |
| England & Wales | | |
| | | EU Directive 2002/91/EC |

Approx. Gross Internal Floor Area 3031 sq. ft / 281.66 sq. m.

Illustration for identification purposes only, measurements are approximate and not to scale, unauthorized reproduction is prohibited.

Produced by designimperial.com