

Grasmere Road, Chester, CH2 2LR

£1,325

Council Tax Band: B



Welcome to this charming property located on Grasmere Road in the picturesque city of Chester. This delightful house boasts a spacious reception room, perfect for entertaining guests or relaxing with your family.

Situated in a sought-after area, this newly refurbished house offers the convenience of parking for up to four vehicles, making it ideal for families or those who enjoy having guests over. The low maintenance garden is perfect for those who want to enjoy outdoor space without the hassle of extensive upkeep.

Don't miss the opportunity to make this house your home, with its convenient location, ample parking, and comfortable living spaces. Contact us today to arrange a viewing and discover the potential this property holds for you and your loved ones.



Open House Whitchurch

### First Floor

Approx. 43.0 sq. metres (462.4 sq. feet)

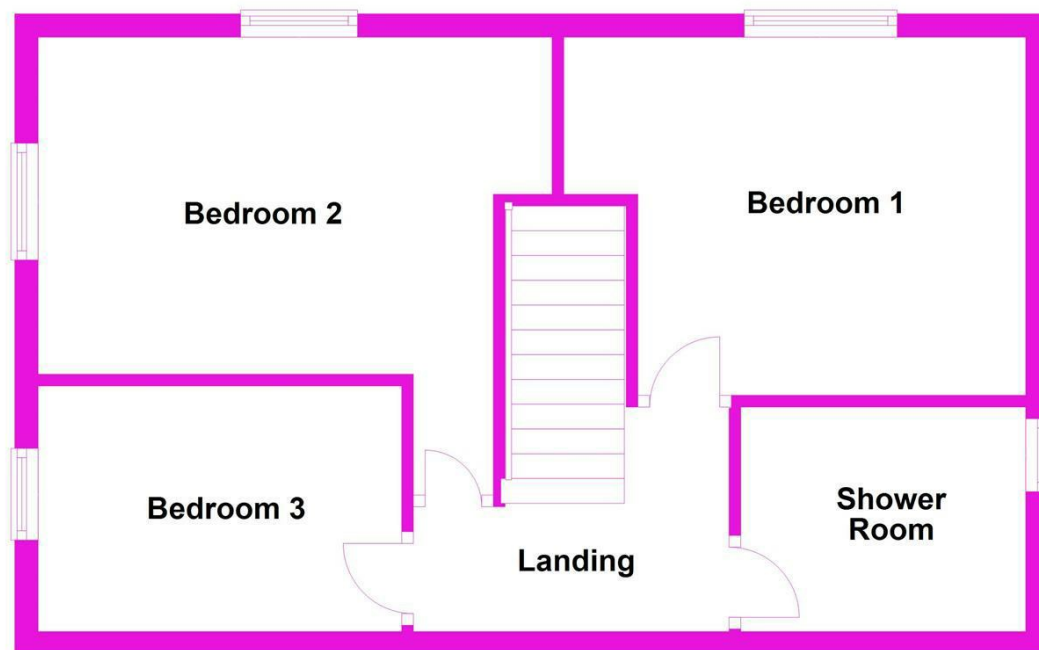

Total area: approx. 43.0 sq. metres (462.4 sq. feet)

All sizes are approximate and are not to be taken literally.  
Plan produced using PlanUp.

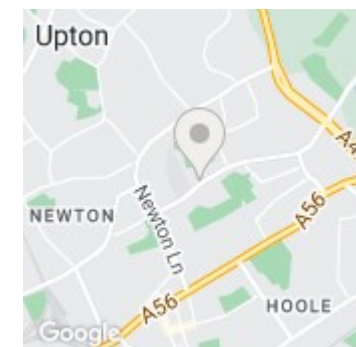

Energy Efficiency Rating		Current	Potential
Very energy efficient - lower running costs			
(92 plus) <b>A</b>			83
(81-91) <b>B</b>			
(69-80) <b>C</b>			
(55-68) <b>D</b>		67	
(39-54) <b>E</b>			
(21-38) <b>F</b>			
(1-20) <b>G</b>			
Not energy efficient - higher running costs			
<b>England &amp; Wales</b>		EU Directive 2002/91/EC	