

Tillering Lane, Scartho Top, Grimsby, North East Lincolnshire, DN33

3TS

£1,500 Per Month

Call 01472 311111





Welcome to this stunning detached house located on Tilling Lane in the sought-after area of Scartho Top. This impressive property boasts two spacious reception rooms, perfect for entertaining guests or simply relaxing with your family. With six generously sized bedrooms, there is plenty of space for everyone to enjoy.

The house features a modern bathroom, providing convenience and comfort for the whole household. Spanning over 2,000 square feet, this home offers ample room for all your needs and desires. Built in 2015, this property combines contemporary design with quality construction, ensuring a stylish and functional living space.

Located in a desirable neighbourhood, this house is ideal for those looking for a peaceful and family-friendly environment. Whether you're looking to host gatherings in the spacious reception rooms or unwind in one of the five bedrooms, this property offers the perfect blend of comfort and style.

Don't miss out on the opportunity to make this house your home. Contact us today to arrange a viewing and experience the charm and elegance of this beautiful property on Tilling Lane.



Open House East Coast

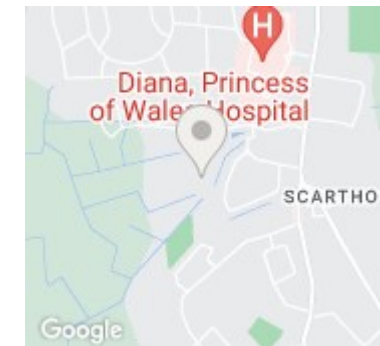
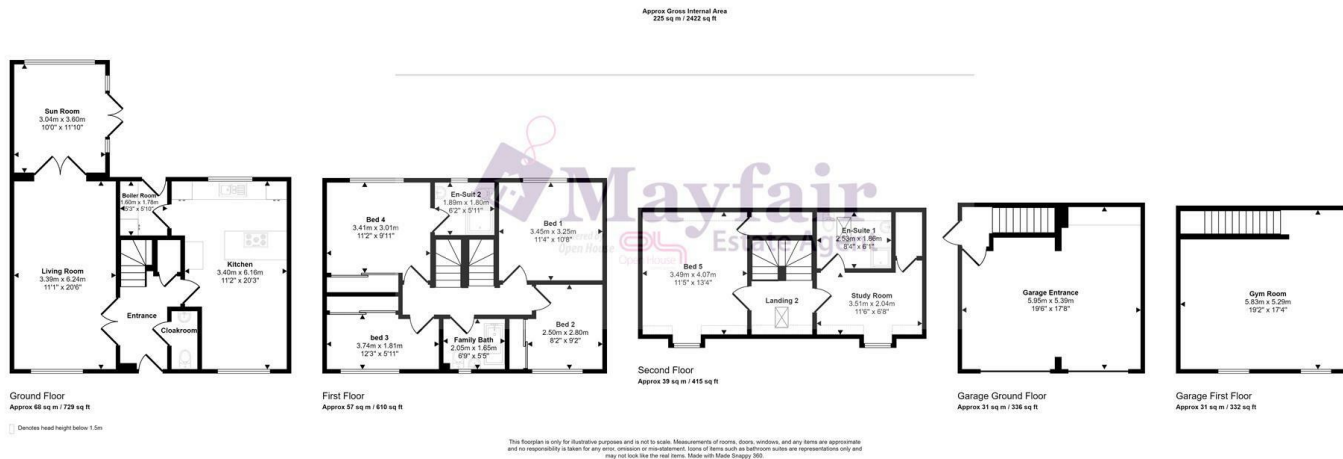

Energy Efficiency Rating		Current	Potential
Very energy efficient - lower running costs			
(92 plus)	A		91
(81-91)	B	82	
(69-80)	C		
(55-68)	D		
(39-54)	E		
(21-38)	F		
(1-20)	G		
Not energy efficient - higher running costs			
<b>England &amp; Wales</b>		EU Directive 2002/91/EC	