

12 Whiteway Close, St Annes, Bristol, BS4 4DQ

£285,000

Council Tax Band: B



We are delighted to present this two bedroom terraced house in a cul-de-sac location in St Annes, Bristol. The accommodation consists of, to the ground floor, a porch way, hall, kitchen and lounge/diner. Upstairs there are two double bedrooms and a family bathroom. There is an enclosed rear garden with an access gate. The property has, unusually, three allocated parking spaces.

Since purchasing the property in 2017 the owners have upgraded the property with a new bathroom, internal doors, had the loft boarded, had a new front door, new soffits, fascias and guttering and a new patio and fencing at the rear. Close to the city centre it is ideally placed for anyone working in central Bristol. We believe this property will appeal to first time buyers, professional couples, down sizers and buy to let investors.

This property is subject to council tax band B



Open House Bristol North East New

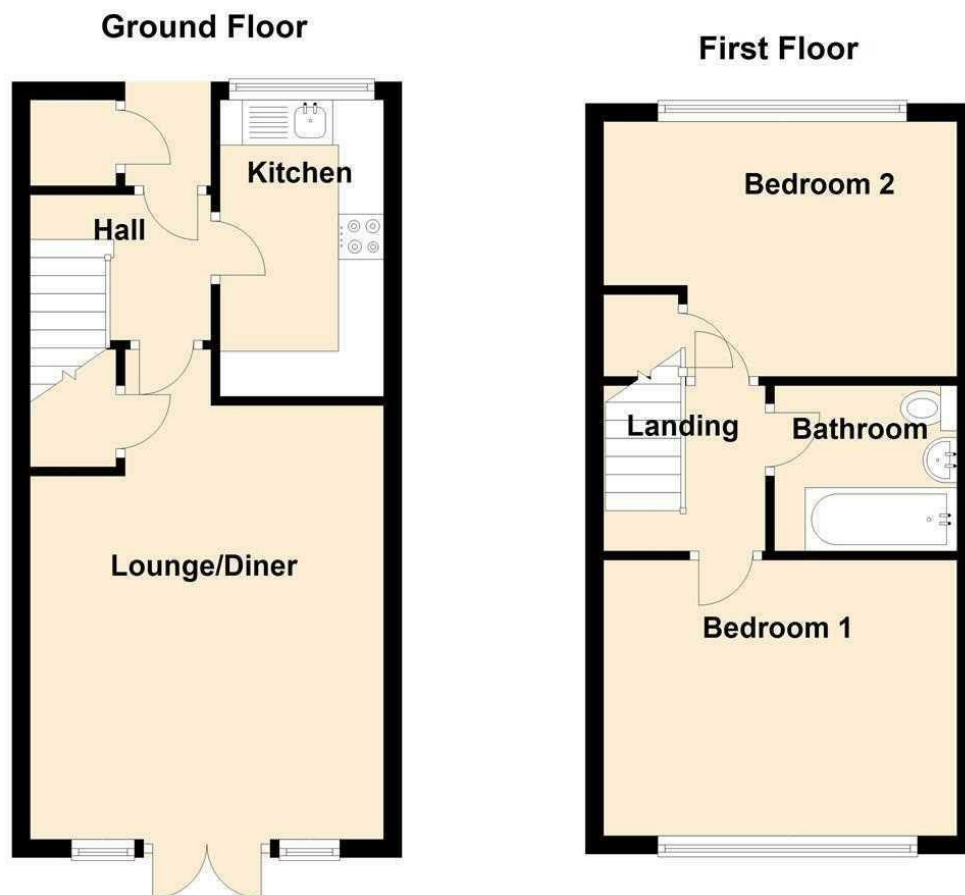

Energy Efficiency Rating		
	Current	Potential
Very energy efficient - lower running costs		
(92 plus) A		
(81-91) B		87
(69-80) C		
(55-68) D	63	
(39-54) E		
(21-38) F		
(1-20) G		
Not energy efficient - higher running costs		
England & Wales	EU Directive 2002/91/EC	