

Lavender Cottage, 3 Poplar Way, North Colerne, Chippenham,
Wiltshire, SN14 8PP
Offers Over £240,000



Lavender Cottage is a delightfully presented three bedroom terraced house in Colerne. The accommodation consists of, to the ground floor, a lounge and kitchen/diner.

Upstairs there are three bedrooms and a family bathroom.

The property benefits from a large rear garden. There is scope to extend to the rear (subject to planning permission).

In a rural location with good access to Bath and Chippenham via main roads and close to Colerne village with its shop and Pubs.

A home that will appeal to first time buyers, down sizers and investors alike.

This property is rated B for Council Tax purposes.

Viewing highly recommended and strictly by appointment only.



Open House Bristol North East New

Ground Floor



First Floor

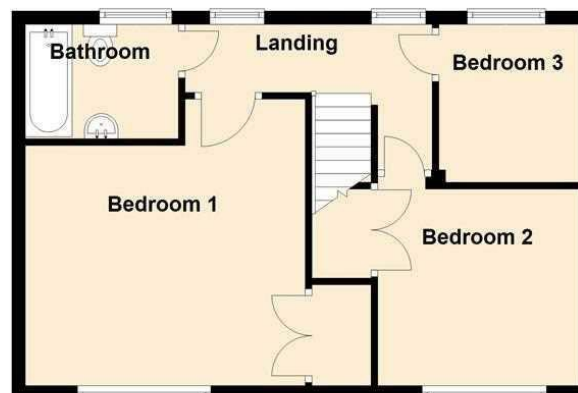

Energy Efficiency Rating		Current	Potential
<i>Very energy efficient - lower running costs</i>			
(92 plus) A			83
(81-91) B		69	
(69-80) C			
(55-68) D			
(39-54) E			
(21-38) F			
(1-20) G			
<i>Not energy efficient - higher running costs</i>			
England & Wales		EU Directive 2002/91/EC	