

The Clockmakers Cottage, Lower Church Street, Ashby-De-La-Zouch,
LE65 1AB
£600,000



This property is currently running as an established BnB business with 3 bedrooms, separated from the 2-bedroom residential section. Both sides of the property are on the same title. The layout is perfect for its current usage, though the property could also make an especially spacious 5-bedroom home in a beautiful location.



Open House Burton & Swadlincote

Lower Church Street, Ashby-de-la-Zouch

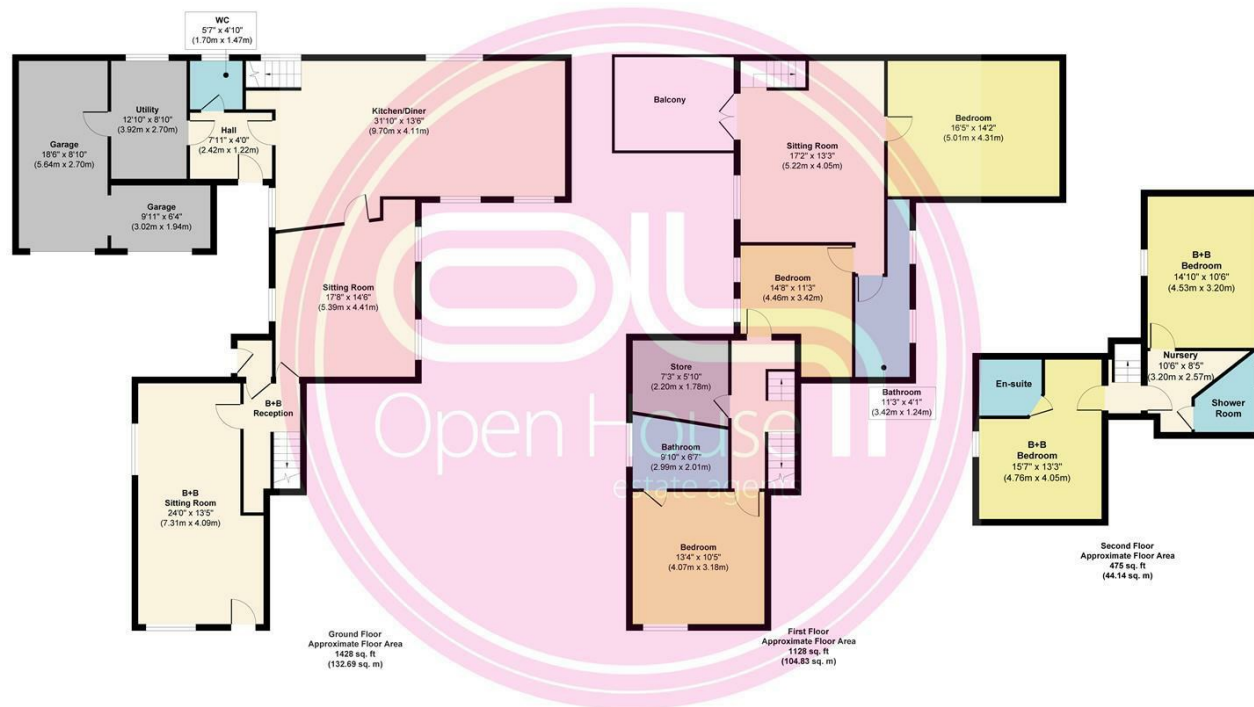

Approx. Gross Internal Floor Area 3031 sq. ft / 281.66 sq. m.

Illustration for identification purposes only, measurements are approximate and not to scale, unauthorized reproduction is prohibited.

Produced by designimperial.com

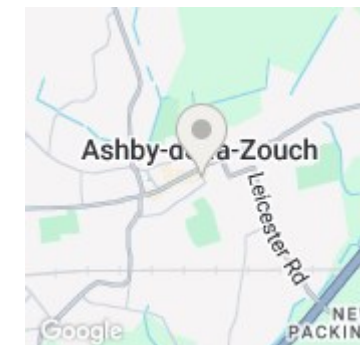

Energy Efficiency Rating		Current	Potential
Very energy efficient - lower running costs			
(92 plus)	A		
(81-91)	B		
(69-80)	C		
(55-68)	D	55	77
(39-54)	E		
(21-38)	F		
(1-20)	G		
Not energy efficient - higher running costs			
England & Wales		EU Directive 2002/91/EC	