



## Castlebar Park, W5

LONG LET. This stunning one-bedroom flat is set within this stunning development and offers a great location close to the popular Pitshanger Village.

- ONE BEDROOM FLAT
- GREAT LOCATION
- PRIVATE DEVELOPMENT
- MODERN KITCHEN
- AVAILABLE 17TH JULY
- OFF STREET PARKING

£1,700 PCM

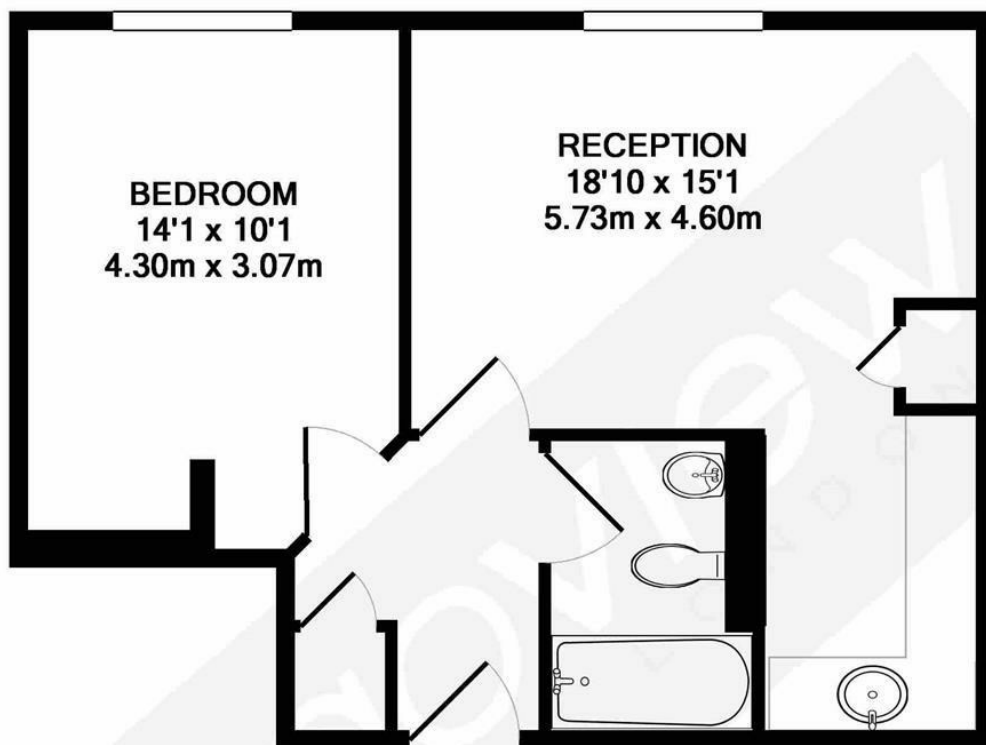

TOTAL APPROX. FLOOR AREA 430 SQ.FT. (39.9 SQ.M.)

Whilst every attempt has been made to ensure the accuracy of the floor plan contained here, measurements of doors, windows, rooms and any other items are approximate and no responsibility is taken for any error, omission, or mis-statement. This plan is for illustrative purposes only and should be used as such by any prospective purchaser. The services, systems and appliances shown have not been tested and no guarantee as to their operability or efficiency can be given

Made with Metropix ©2017



Energy Efficiency Rating		
	Current	Potential
Very energy efficient - lower running costs		
(92 plus) <b>A</b>		
(81-91) <b>B</b>		
(69-80) <b>C</b>		
(55-68) <b>D</b>		
(39-54) <b>E</b>		
(21-38) <b>F</b>		
(1-20) <b>G</b>		
Not energy efficient - higher running costs		
<b>England &amp; Wales</b>	EU Directive 2002/91/EC	