



Coldershaw Road, W13

LONG LET. This beautiful two-bedroom garden flat has been finished to a very high specification and is set in a great location in the heart of West Ealing.

- GARDEN FLAT
- TWO DOUBLE BEDROOMS
- WEST EALING
- PERIOD FEATURES
- GREAT LOCATION
- SEPARATE KITCHEN

£2,050 PCM

Coldershaw Rd

Approximate Gross Internal Area
710 sq ft - 66 sq m

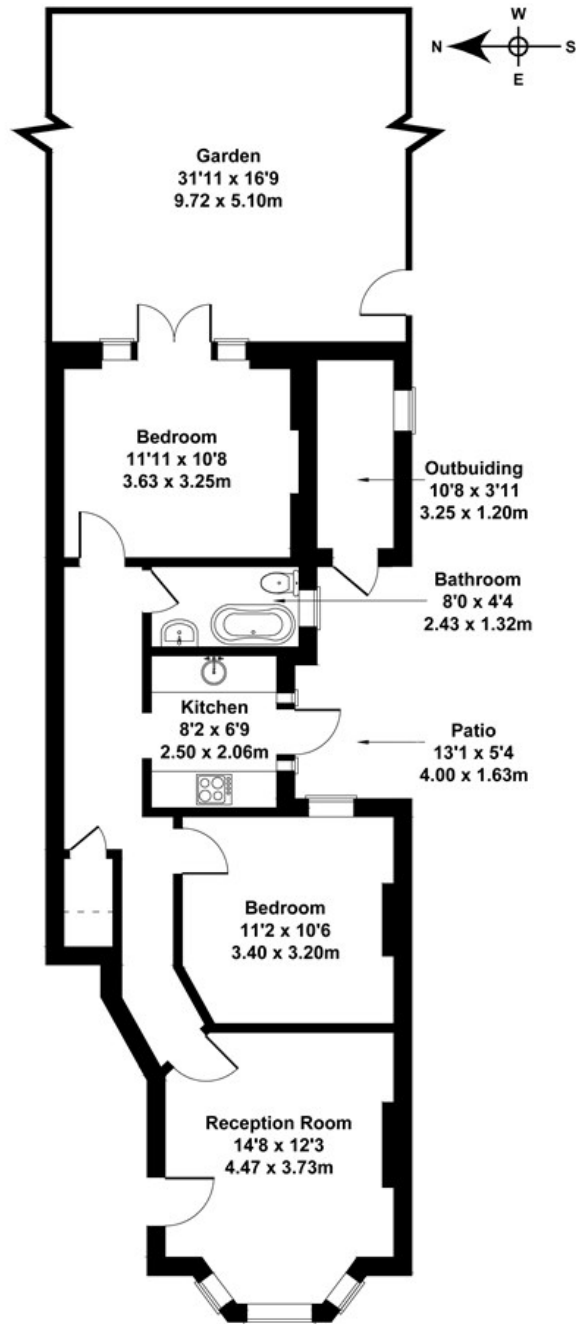

GROUND FLOOR

Not to Scale. Produced by The Plan Portal 2022
For Illustrative Purposes Only.

Energy Efficiency Rating		
	Current	Potential
Very energy efficient - lower running costs		
(92 plus) A		
(81-91) B		
(69-80) C		
(55-68) D		
(39-54) E		
(21-38) F		
(1-20) G		
Not energy efficient - higher running costs		
England & Wales	EU Directive 2002/91/EC	