



Uxbridge Road, W3

LONG LET. A bright, spacious and recently renovated two bedroom flat is available for immediate occupation and is within walking distance of local transport.

- Available now
- Two bedrooms
- Close to local transport
- Permit parking
- Close to amenities
- Early viewing advised

£1,895

West Lodge Court

Approximate Gross Internal Area
505 sq ft - 47 sq m

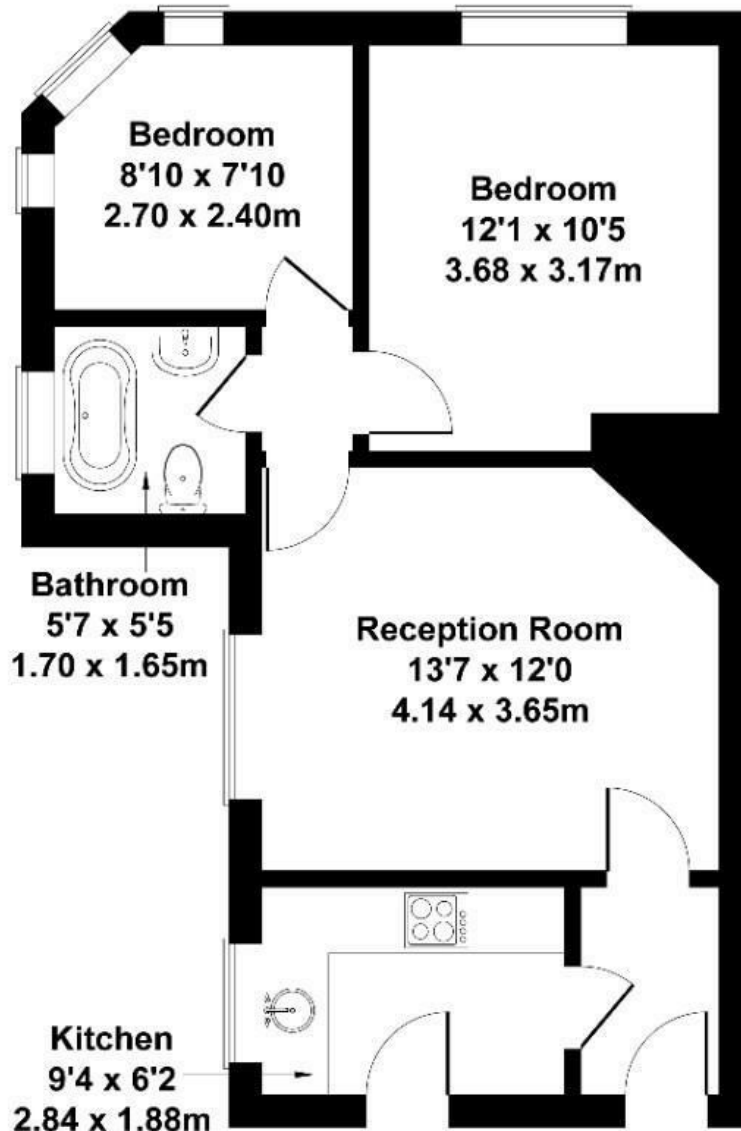
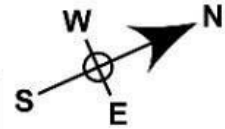

SECOND FLOOR

Not to Scale. Produced by The Plan Portal 2024
For Illustrative Purposes Only.

Energy Efficiency Rating		Current	Potential
Very energy efficient - lower running costs			
(92 plus) A			
(81-91) B			
(69-80) C			
(55-68) D		57	
(39-54) E			
(21-38) F			
(1-20) G			
Not energy efficient - higher running costs			
England & Wales	EU Directive 2002/91/EC		