



Donne Court, W3

Located within this new purpose-built building as part of the awe-inspiring Acton Gardens development is this sizeable two-bedroom, two-bathroom apartment with private south facing balcony with views from its vantage point on the 4th floor of the building. Two notable features are the large utility and the secure bike storage located on the ground floor which are rare for flats in London.

- Purpose built 2019
- Two double bedrooms
- Two bathrooms
- Fourth floor with lift
- Underground secure parking
- Excellent condition throughout
- South facing balcony
- Long lease 243 years
- Bike storage
- Short walk Acton Town tube station- Piccadilly & District lines

£575,000

Donne Court

Approximate Gross Internal Area
786 sq ft - 73 sq m

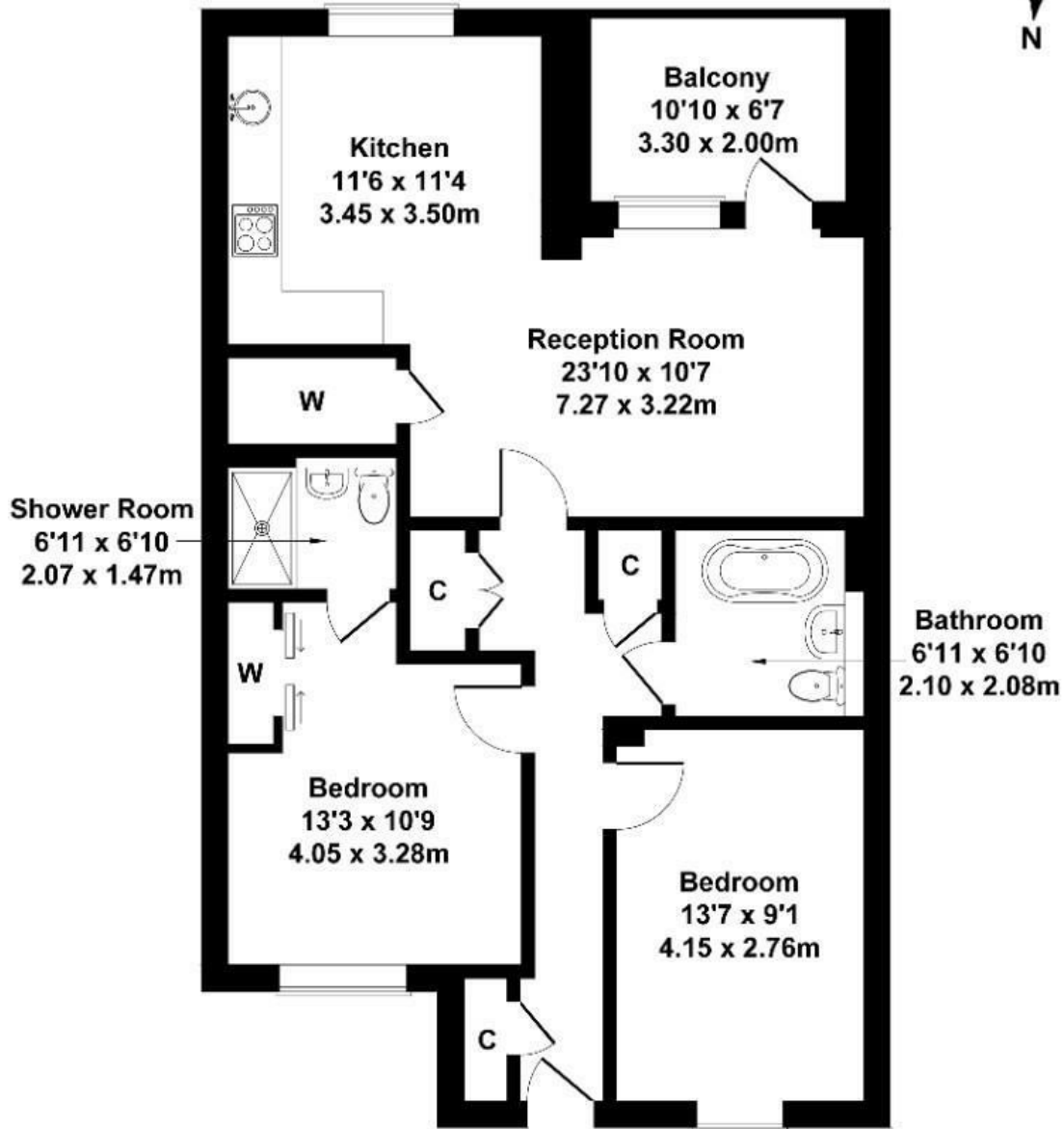

FORTH FLOOR

Not to Scale. Produced by The Plan Portal 2024
For Illustrative Purposes Only.

Energy Efficiency Rating		
	Current	Potential
<i>Very energy efficient - lower running costs</i>		
(92 plus) A		
(81-91) B	85	85
(69-80) C		
(55-68) D		
(39-54) E		
(21-38) F		
(1-20) G		
<i>Not energy efficient - higher running costs</i>		
England & Wales	EU Directive 2002/91/EC	