



Broughton Road, W13

LONG LET. This one bedroom flat benefits from a great location moments from West Ealing Station (Elizabeth line).

- Top floor flat
- Managed by Go View London
- Open plan living
- Moments from the Elizabeth Line
- Close to local bars and restaurants

£1,400 PCM

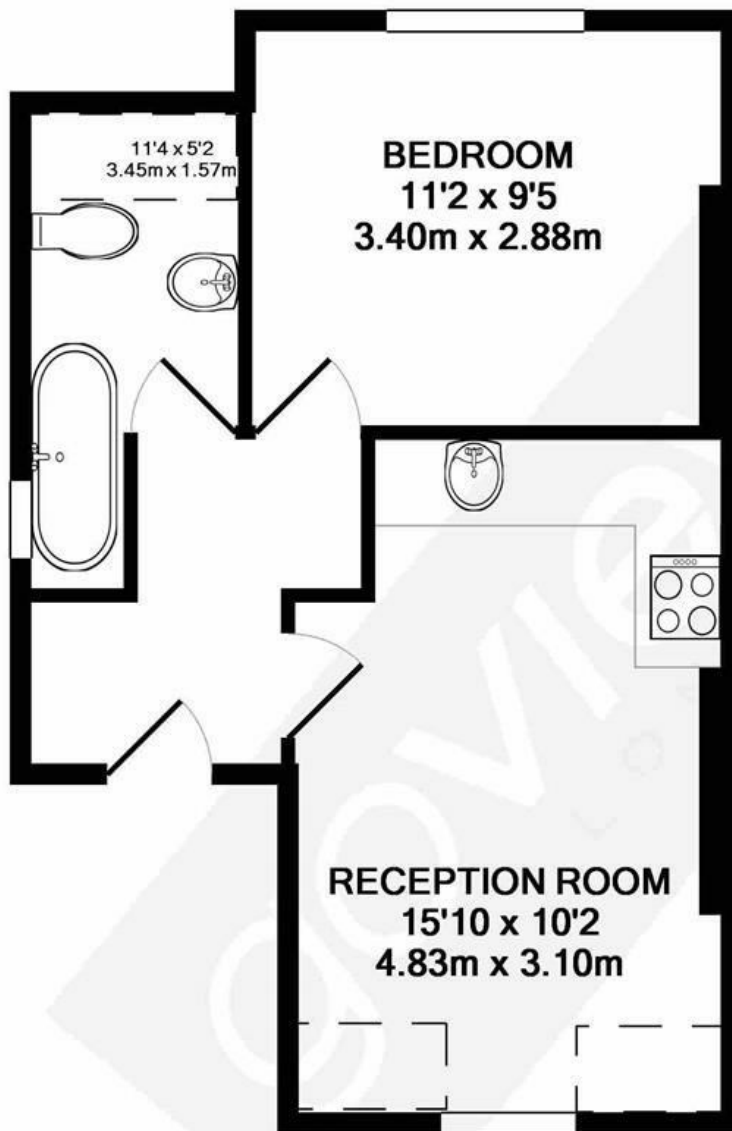

TOTAL APPROX. FLOOR AREA 345 SQ.FT. (32.1 SQ.M.)

Whilst every attempt has been made to ensure the accuracy of the floor plan contained here, measurements of doors, windows, rooms and any other items are approximate and no responsibility is taken for any error, omission, or mis-statement. This plan is for illustrative purposes only and should be used as such by any prospective purchaser. The services, systems and appliances shown have not been tested and no guarantee as to their operability or efficiency can be given
 Made with Metropix ©2017

Energy Efficiency Rating		
	Current	Potential
<i>Very energy efficient - lower running costs</i>		
(92 plus) A		
(81-91) B		
(69-80) C		
(55-68) D		
(39-54) E		
(21-38) F		
(1-20) G		
<i>Not energy efficient - higher running costs</i>		
England & Wales	EU Directive 2002/91/EC	