



Langham Gardens, London

LONG LET. This fantastic two bedroom, two bathroom flat features a generous reception room and boasts a great location in the heart of Ealing.

- TWO DOUBLE BEDROOMS
- TWO BATHROOMS
- CLOSE TO TRANSPORT LINKS
- GREAT LOCATION
- HIGH STANDARD
- SEPARATE KITCHEN

£2,000 Per Month

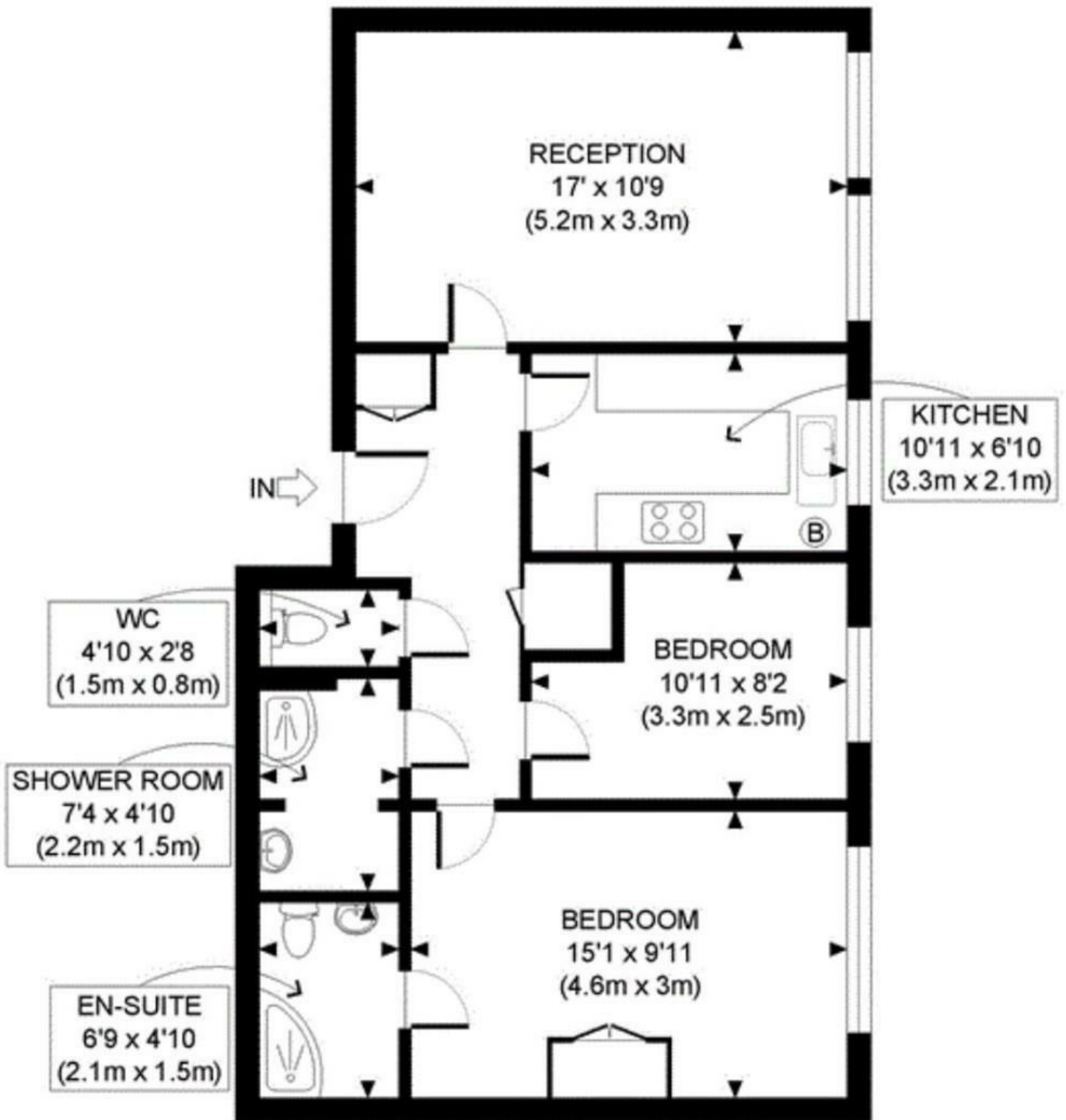

Energy Efficiency Rating		
	Current	Potential
<i>Very energy efficient - lower running costs</i>		
(92 plus) A		
(81-91) B		
(69-80) C		
(55-68) D		
(39-54) E		
(21-38) F		
(1-20) G		
<i>Not energy efficient - higher running costs</i>		
England & Wales	EU Directive 2002/91/EC	

