



## Glebe Court, Grange Road, London

Set on the ground floor of this popular three-storey development is this two double bedroom apartment in a prime residential spot just a short distance from the heart of Ealing Broadway.

The property is well-proportioned and set up as two double bedrooms that measures close to 800 sq ft with large eat in kitchen (10'2 x 9'8) and reception (15' x 14') and comes with a private garage, large well-groomed communal grounds, a share of the freehold and no onward chain

- Two double bedrooms
- Purpose built
- Ground floor flat
- Garage
- Share of Freehold
- Short walk to Ealing Broadway
- No chain
- Good condition throughout
- Utility room
- Close to multiple public transport links

£525,000

# Glebe Court

Approximate Gross Internal Area  
786 sq ft - 73 sq m  
(Excluding Garage)

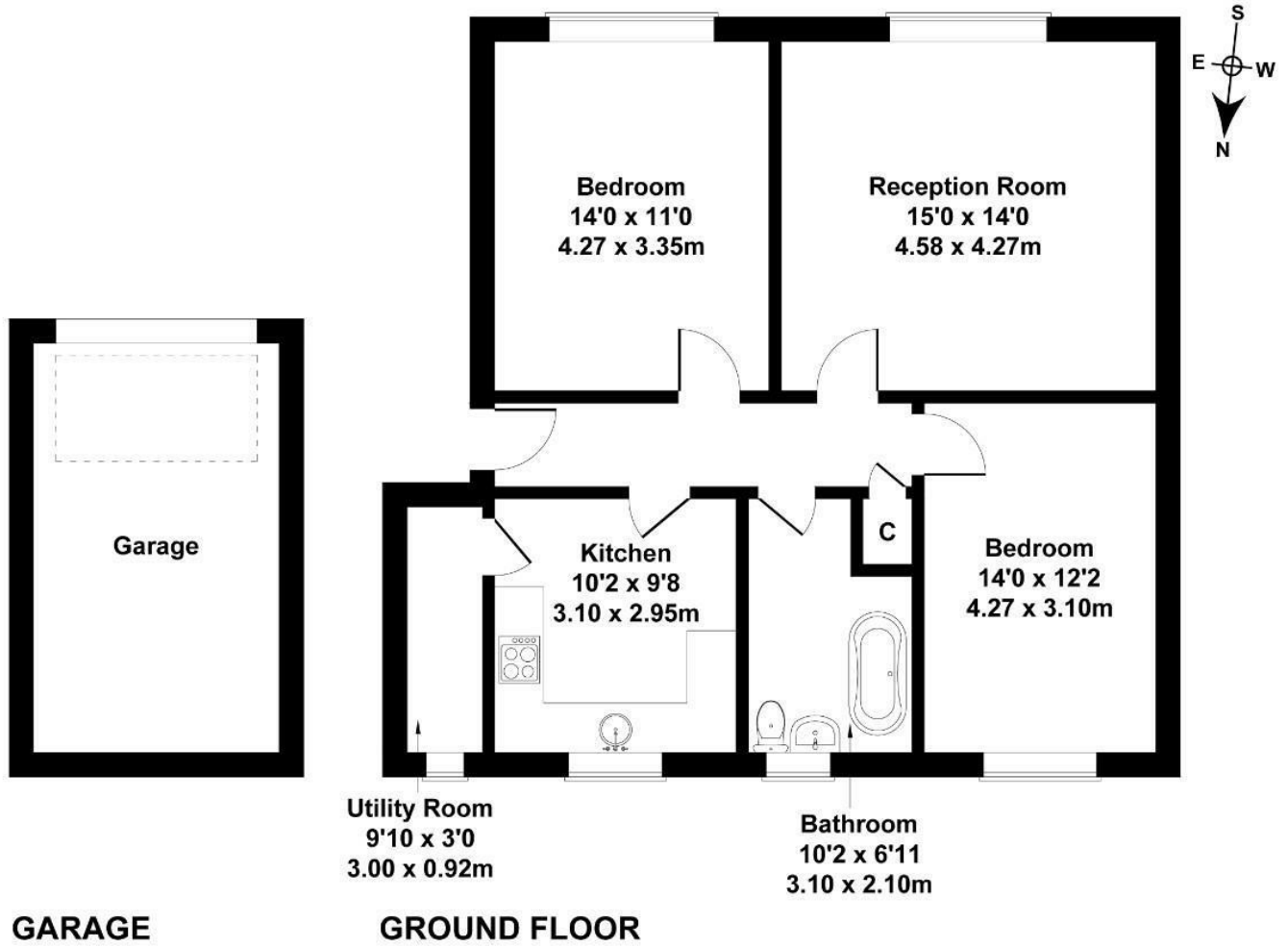

Not to Scale. Produced by The Plan Portal 2024  
For Illustrative Purposes Only.

| Energy Efficiency Rating                           |                         |           |
|--|-------------------------|-----------|
|  | Current                 | Potential |
| <i>Very energy efficient - lower running costs</i> |                         |           |
| (92 plus) <b>A</b>                                 |                         |           |
| (81-91) <b>B</b>                                   |                         |           |
| (69-80) <b>C</b>                                   | 69                      | 75        |
| (55-68) <b>D</b>                                   |                         |           |
| (39-54) <b>E</b>                                   |                         |           |
| (21-38) <b>F</b>                                   |                         |           |
| (1-20) <b>G</b>                                    |                         |           |
| <i>Not energy efficient - higher running costs</i> |                         |           |
| <b>England &amp; Wales</b>                         | EU Directive 2002/91/EC |           |