



## Ealing Common, W5

LONG LET. Located close to transport links, this stunning three bedroom flats boasts a contemporary interior decor and is close to the local amenities of Ealing Common.

- THREE DOUBLE BEDROOMS
- CONTEMPORARY DECOR
- SECURE PARKING
- EALING COMMON
- TWO BATHROOMS
- GREAT LOCATION

£2,950 PCM

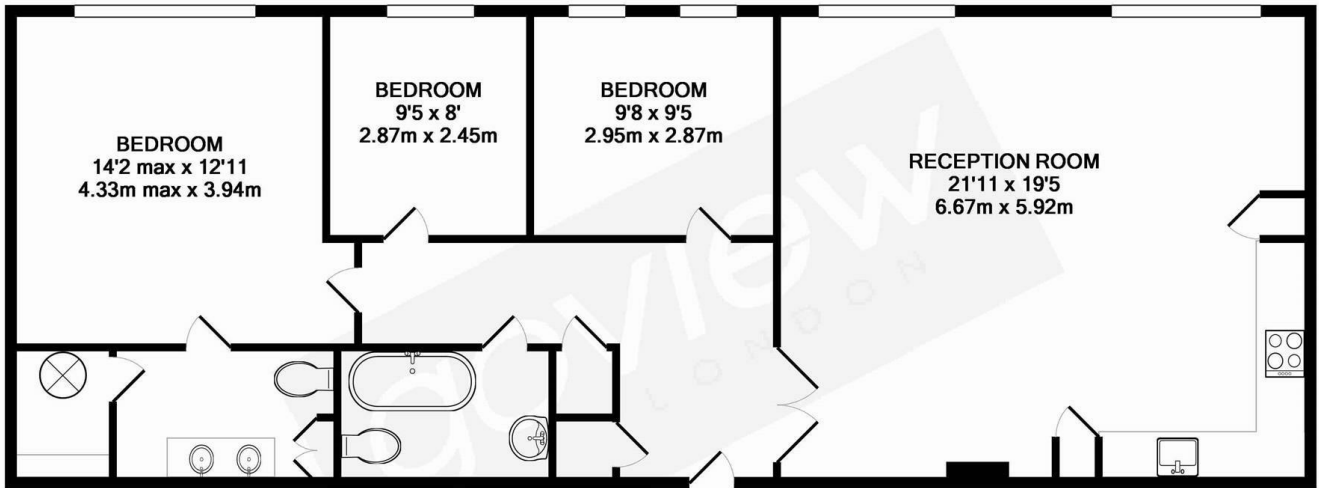

TOTAL APPROX. FLOOR AREA 1140 SQ.FT. (105.9 SQ.M.)

Whilst every attempt has been made to ensure the accuracy of the floor plan contained here, measurements of doors, windows, rooms and any other items are approximate and no responsibility is taken for any error, omission, or mis-statement. This plan is for illustrative purposes only and should be used as such by any prospective purchaser. The services, systems and appliances shown have not been tested and no guarantee as to their operability or efficiency can be given  
Made with Metropix ©2014

Energy Efficiency Rating		Current	Potential
Very energy efficient - lower running costs			
(92 plus) <b>A</b>			
(81-91) <b>B</b>			
(69-80) <b>C</b>		78	82
(55-68) <b>D</b>			
(39-54) <b>E</b>			
(21-38) <b>F</b>			
(1-20) <b>G</b>			
Not energy efficient - higher running costs			
<b>England &amp; Wales</b>	EU Directive 2002/91/EC		