



Gordon Road, London

A stunning two-bedroom period garden flat located moments from Ealing Broadway centre.

Set on Gordon Road which is a residential area that is well-known for its beautiful homes and tranquil surroundings. The property offers two bedrooms, separate fully fitted kitchen, stylish family bathroom, direct access to well-groomed communal gardens, private garage and share of the freehold.

- Ground floor flat
- Period conversion
- Private garage
- Share of freehold
- Close to Ealing Broadway
- Direct access to a communal garden

£500,000

Gordon Road

Approximate Gross Internal Area
732 Sq Ft / 68 Sq M

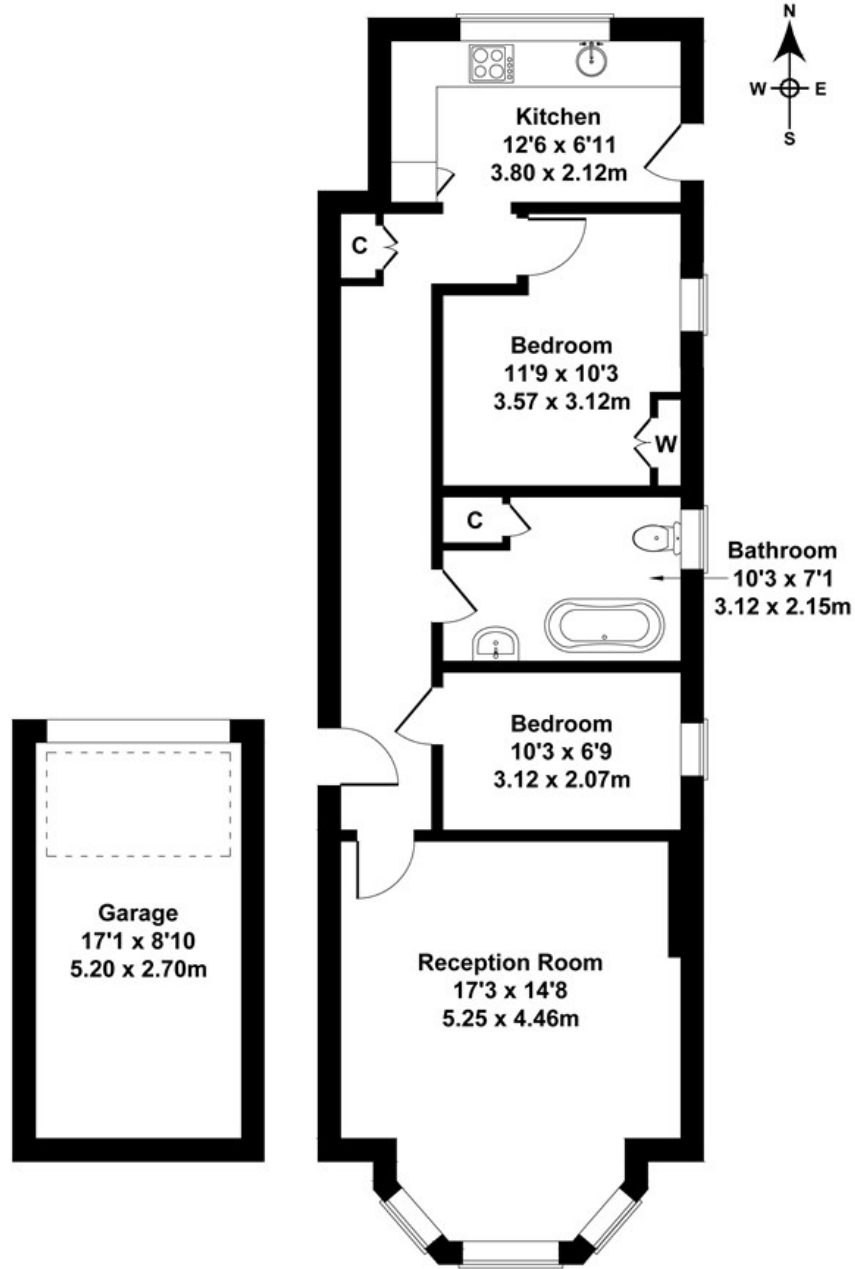

GARAGE

GROUND FLOOR

Not to Scale. Produced by The Plan Portal 2023
For Illustrative Purposes Only.

Energy Efficiency Rating		Current	Potential
Very energy efficient - lower running costs			
(92 plus) A			
(81-91) B			
(69-80) C		69	77
(55-68) D			
(39-54) E			
(21-38) F			
(1-20) G			
Not energy efficient - higher running costs			
England & Wales		EU Directive 2002/91/EC	