



## Saxon Drive, London

LONG LET. This spacious and beautifully presented three double bedroom house is situated in a leafy residential street offering a modern interior and private garden.

- FAMILY HOME
- LARGE DOUBLE ROOMS
- GREAT LOCATION
- PLENTY OF STORAGE
- MODERN INTERIOR
- SHARERS WELCOME

£2,750

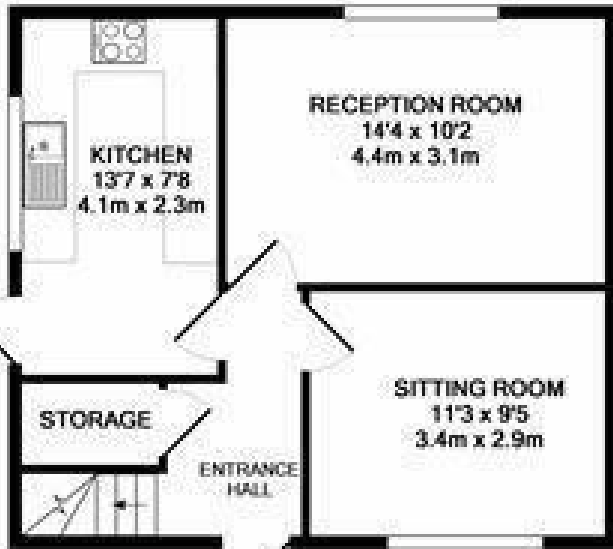

GROUND FLOOR  
APPROX. FLOOR  
AREA 40.0 SQ.M.  
(430 SQ.FT.)

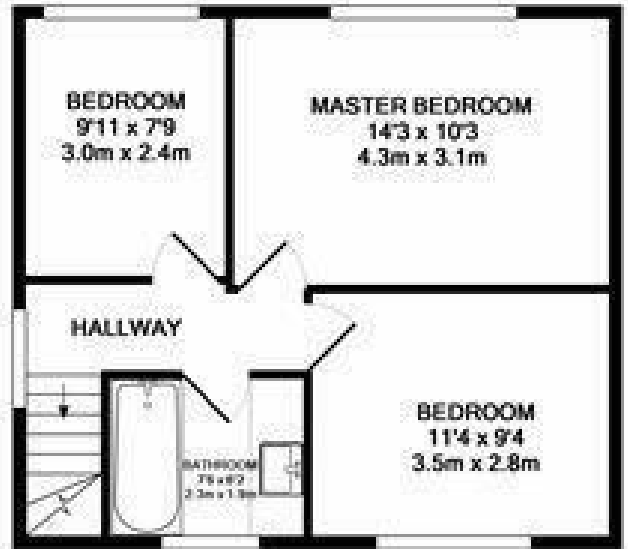

1ST FLOOR  
APPROX. FLOOR  
AREA 40.0 SQ.M.  
(430 SQ.FT.)

TOTAL APPROX. FLOOR AREA 80.0 SQ.M. (861 SQ.FT.)

Whilst every attempt has been made to ensure the accuracy of the floor plan contained here, measurements of doors, windows, rooms and any other items are approximate and no responsibility is taken for any error, omission, or mis-statement. This plan is for illustrative purposes only and should be used as such by any prospective purchaser. The services, systems and appliances shown have not been tested and no guarantee is given for their operability or efficiency can be given.

Made with Metropix ©2010

Energy Efficiency Rating		
	Current	Potential
<i>Very energy efficient - lower running costs</i>		
(92 plus) <b>A</b>		
(81-91) <b>B</b>		
(69-80) <b>C</b>		
(55-68) <b>D</b>		
(39-54) <b>E</b>		
(21-38) <b>F</b>		
(1-20) <b>G</b>		
<i>Not energy efficient - higher running costs</i>		
<b>England &amp; Wales</b>	EU Directive 2002/91/EC	