



Woodfield Road, W5

This two bedroom apartment is part of the iconic 58 Woodfield Rd development that is setting a new standard in the 'new conversion' apartment living in the centre of Ealing.

- Period conversion
- Two double bedrooms
- Top floor flat
- No chain
- Communal gardens
- Finished to high standard
- Close to Pitshanger & Ealing Broadway
- Siemens appliances

£530,000

Woodfield Road

Approximate Gross Internal Area
710 sq ft - 66 sq m

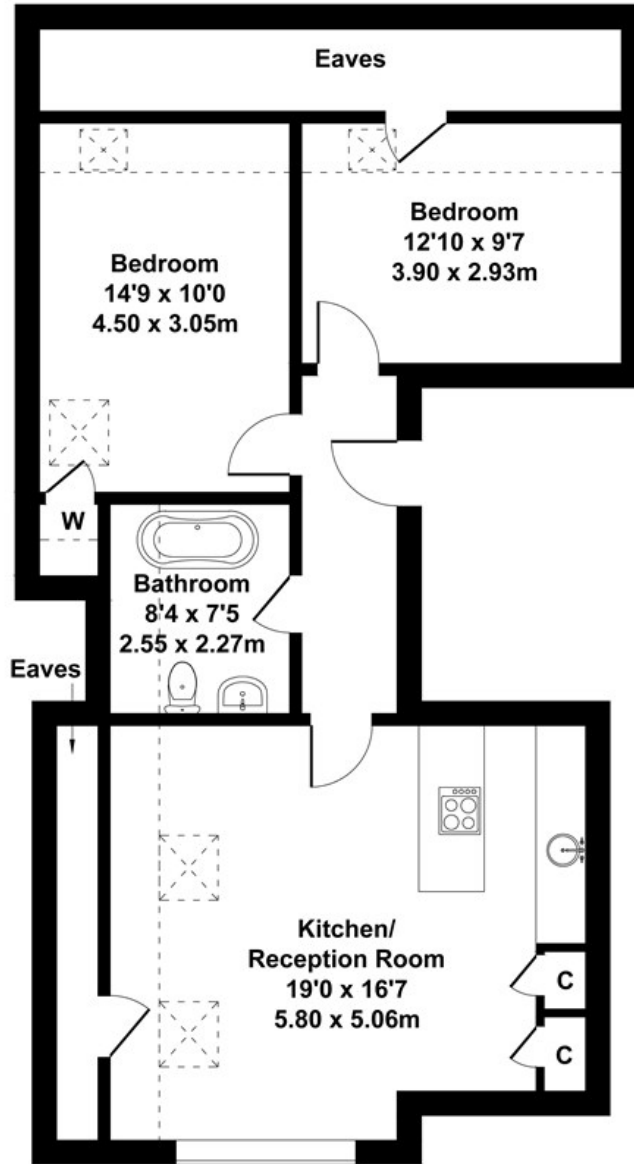

SECOND FLOOR

Not to Scale. Produced by The Plan Portal 2022
For Illustrative Purposes Only.

Energy Efficiency Rating		Current	Potential
Very energy efficient - lower running costs			
(92 plus) A			
(81-91) B		81	81
(69-80) C			
(55-68) D			
(39-54) E			
(21-38) F			
(1-20) G			
Not energy efficient - higher running costs			
England & Wales	EU Directive 2002/91/EC		