



53 Longfield House, Uxbridge Road, London, W5 2SR

A top floor two bedroom apartment set in the Longfield House development in the heart of Ealing Broadway with its array of shops, bars, restaurants and transport links. The property comes with the benefit of off street parking and is offered chain free to the market.

- Purpose built
- Two bedrooms
- Top floor flat
- Allocated off-street parking
- No chain
- Central Ealing location
- Close to transport links
- Ideal rental investment

£325,000

Longfield House

Approximate Gross Internal Area
570 sq ft - 53 sq m

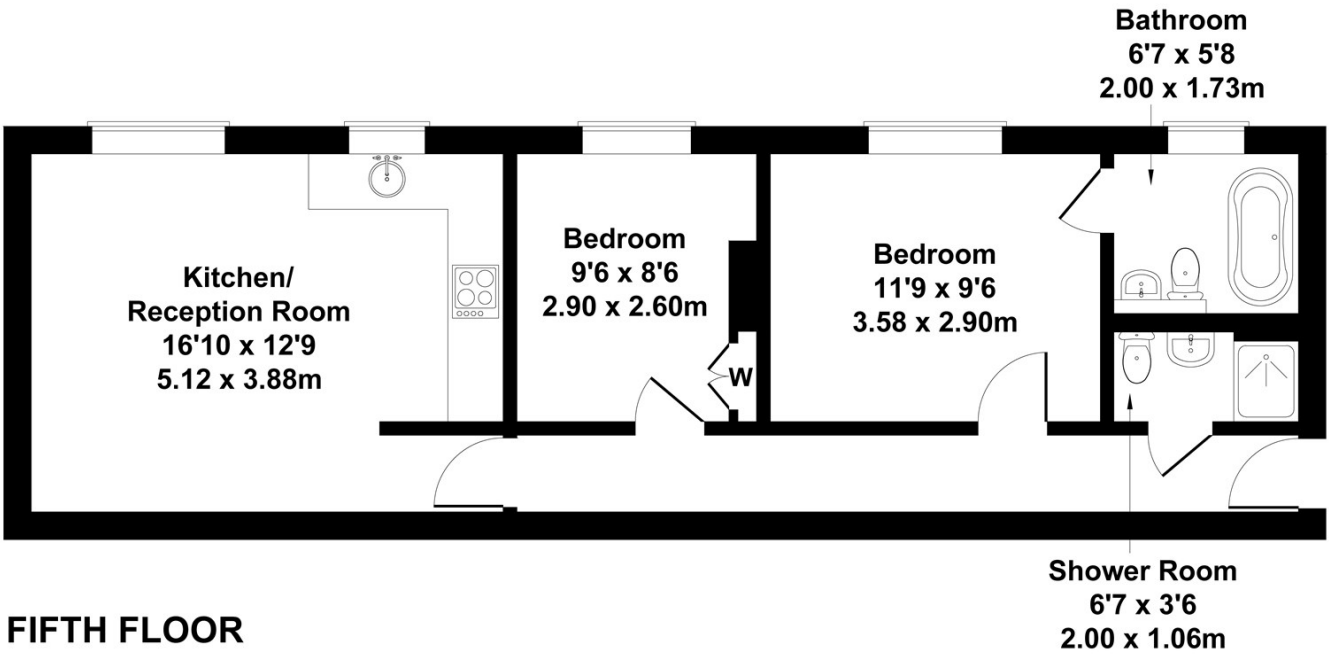
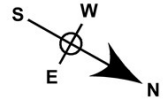

FIFTH FLOOR

Not to Scale. Produced by The Plan Portal 2022
For Illustrative Purposes Only.

Energy Efficiency Rating		Current	Potential
Very energy efficient - lower running costs			
(92 plus) A			
(81-91) B			
(69-80) C			
(55-68) D			
(39-54) E			
(21-38) F			
(1-20) G			
Not energy efficient - higher running costs			
England & Wales		64	80
	EU Directive 2002/91/EC		