

Bartram & Co

FOR SALE

32 Grays Lane, Paulerspury, Towcester, NN12 7NW

£270,000 - Freehold



Council Tax Band: C Service Charge: x Ground Rent: x

- Established Semi-Detached Home
- Popular Village Location
- Extended Ground & First Floor
- Lounge and Kitchen/Dining Room
- Garden Room, Gas Radiator Heating
- Three Beds, Bathroom with Shower
- UPVC Double Glazing Throughout
- Front and Rear Gardens
- EPC Energy Rating: D
- Council Tax Band: C

THE PROPERTY

An established three bedroom property, set back from the road in this popular village. Providing two reception rooms including a good sized living room and kitchen dining room, the property is extended at the front and rear to create three double bedrooms and an additional reception room at the rear. There is also a cloakroom and a family bathroom with a shower. With front and rear gardens this is an excellent family home close to local amenities.

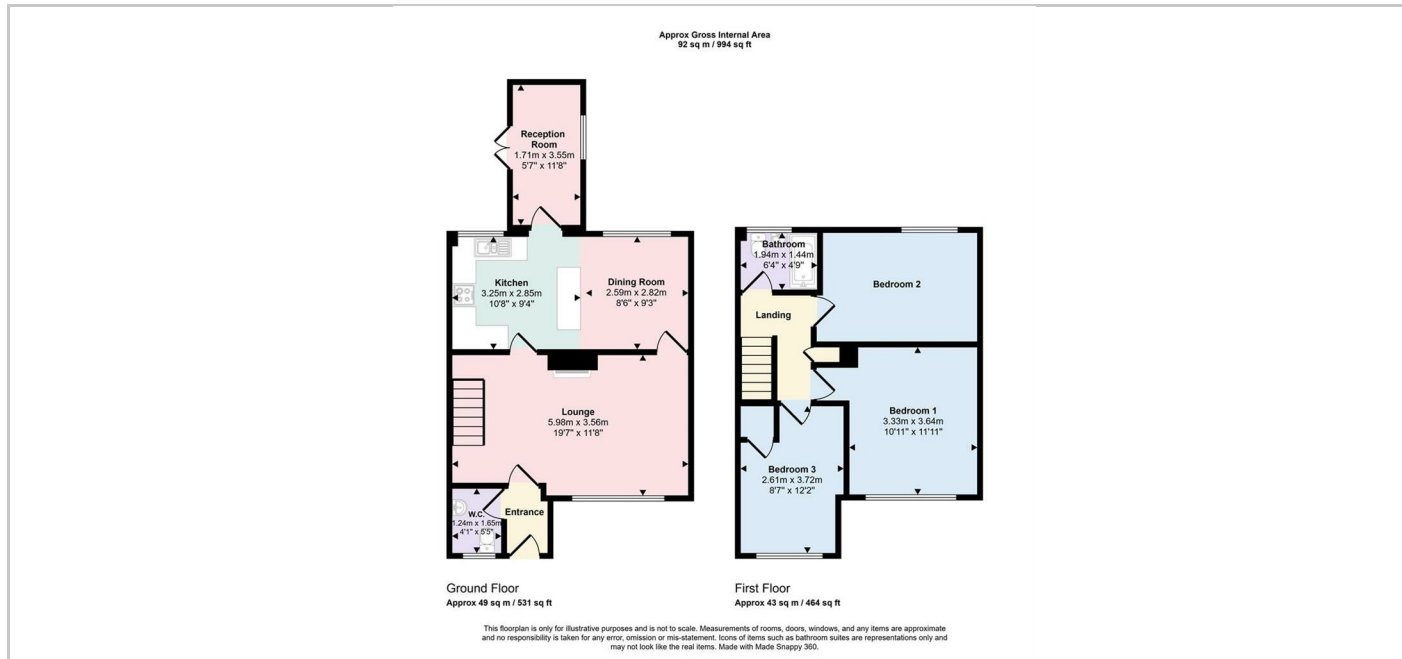

SITUATION

Directions

From our offices in Towcester, head southwest on Chantry Lane towards Watling Street/A5. Turn left onto Watling Street/A5 and continue following the A5. At the first roundabout, take the first exit to stay on the A5, then proceed through the next two roundabouts, taking the first exit each time, continuing on the A5 for approximately 10 miles. Use the left lane to take the slip road towards Milton Keynes Central & East, merging onto H5/Portway/A509. At North Grafton Roundabout, take the second exit to stay on Portway/A509, then at the next roundabout, take the third exit onto Witan Gate, where your destination will be on the left.